

REQUIRED TOOLS AND MATERIALS:



- Two (2) Capable Adults



- Tape Measure



- Wood Board
6" x 6" (scrap)



- Sawhorse or
Support Table

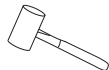

- Hammer

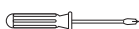

- #2 or #3 Phillips
Screwdriver



- Safety Glasses



- Step Ladder 8ft.
(2.4 m)

- (2 each) Wrenches and/or
Socket Wrenches and
Sockets (Deep-Well Sockets
are Recommended).

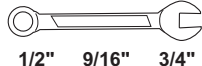

1/2" 9/16" 3/4"

AND/OR



1/2" 9/16" 3/4"



- Extension is Recommended.

- Garden Hose or Sand

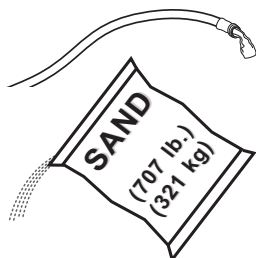

OPTIONAL TOOLS AND MATERIALS:

- Large and Small Adjustable
Wrenches

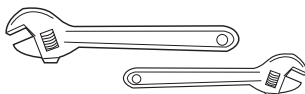

• N53 W24700 South Corporate Circle • Sussex, WI 53089 • U.S.A.

NBA Arena Portable System

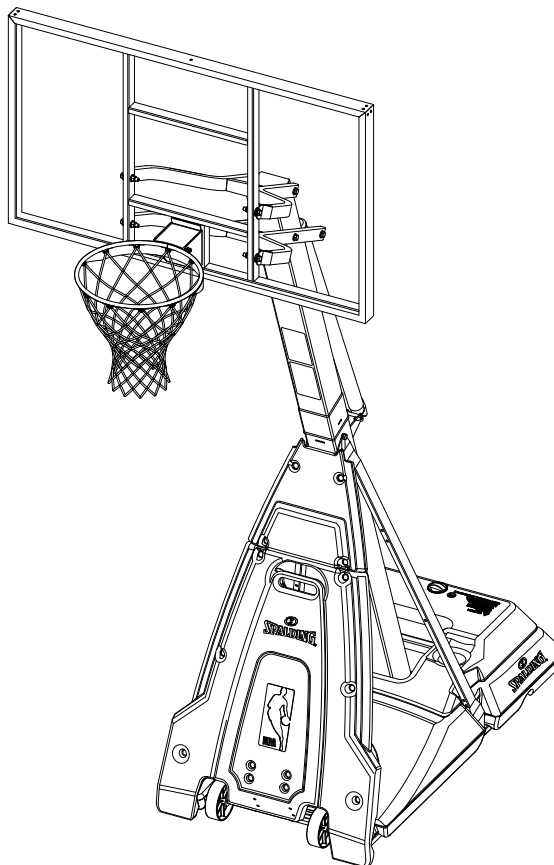

Adult Assembly Required.

This manual, accompanied by sales receipt, should be saved and kept on hand as a convenient reference, as it contains important information about your model.



WARNING!

READ AND UNDERSTAND
OPERATOR'S MANUAL BEFORE
USING THIS UNIT.

FAILURE TO FOLLOW
OPERATING INSTRUCTIONS
COULD RESULT IN INJURY OR
DAMAGE TO PROPERTY.

Write Model Number
From Box Here:

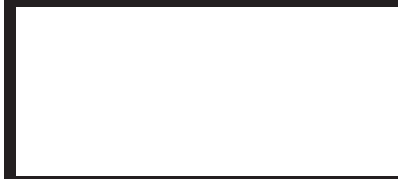

Toll-Free Customer Service Number for U.S: 1-800-558-5234,

For Canada: 1-800-284-8339,

For Europe: 00 800 555 85234 (Sweden: 009 555 85234),

For Australia: 1800 632 792

Internet Address: www.spalding.com

IDENTIFY HARDWARE CARDS

To make the assembly easier we have separated the hardware per section.
Each hardware card is dedicated to a specific assembly area.
Open each individually as you progress through the steps. Do not open them all at once.

BASE TO POLE HARDWARE CARD

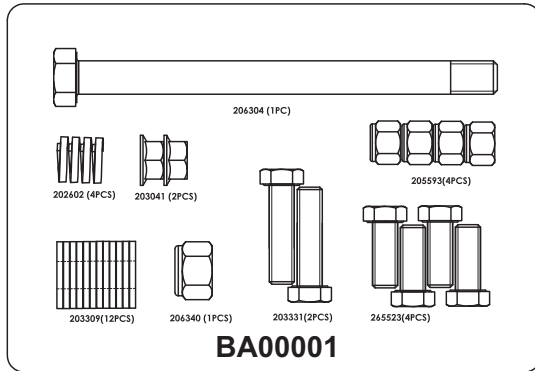

FRONT WHEEL ASSEMBLY HARDWARE CARD

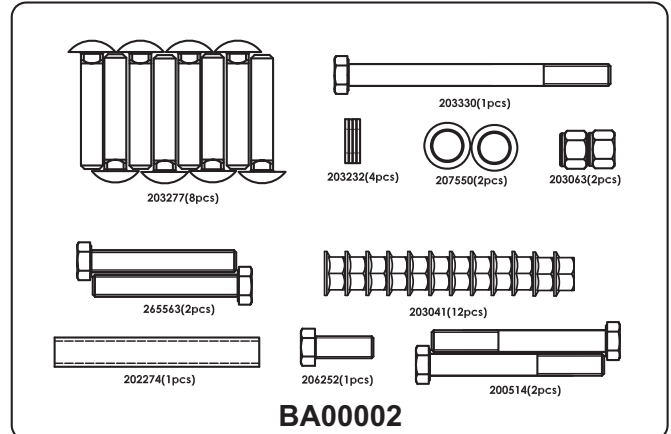

ELEVATOR TO POLE CONNECTION HARDWARE CARD

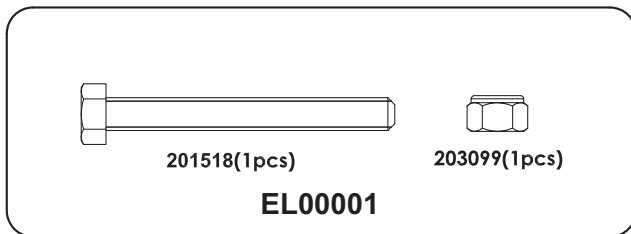

ELEVATOR ARMS HARDWARE CARD

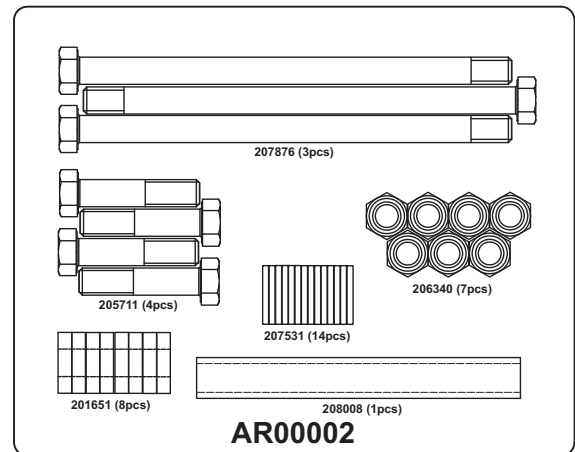

RIM ATTACHMENT HARDWARE CARD AND BAG

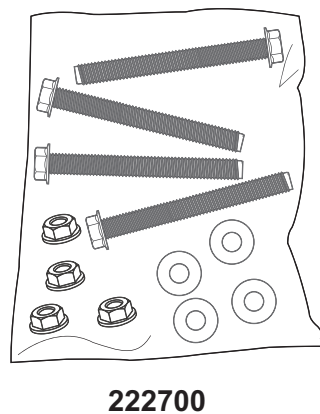
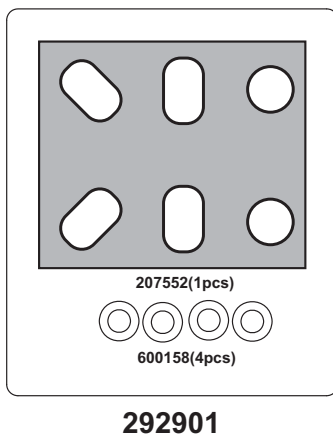

STADIUM AND BOARD PAD HARDWARE CARD

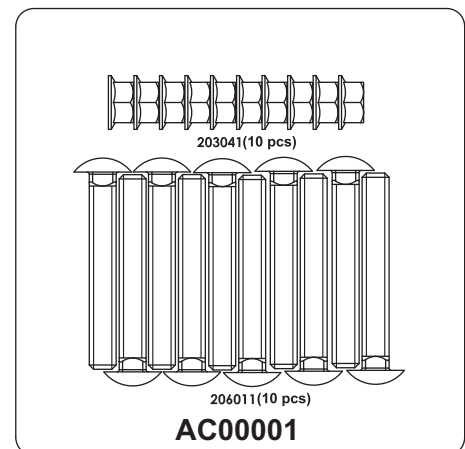



BEFORE YOU START!

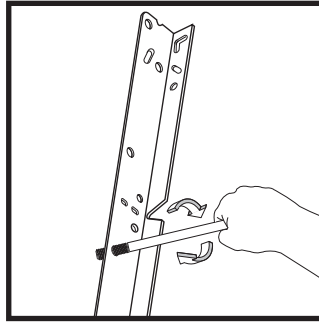
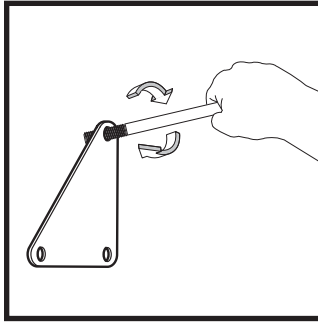
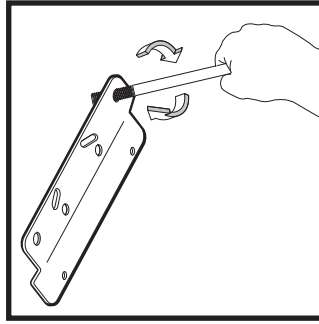
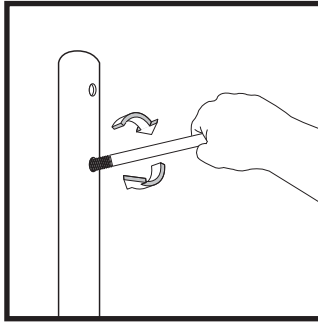

To ensure optimal playability of backboard system, a close tolerance fit between the elevator components and hardware is required. Test-fit large bolts into large holes of elevator tubes, backboard brackets, and triangle plates. Carefully rock them in a circular motion to ream out any excess paint from holes if necessary.

Not all items pictured are included with every model.

HEIGHT ADJUSTMENT

Rotate crank handle to raise and lower backboard.

Do not over crank handle beyond the manufactured height indicator range of 7-1/2 - 10 feet. Damage may be caused to the screw jack's internal adjustment mechanism if adjusted over 10 or under 7-1/2 feet.

MOVING SYSTEM

1. Adjust basketball backboard height to lowest position.
2. Rotate handle forward until wheels engage ground.
3. Move basketball system to desired location.
4. Rotate handle back to original position.
5. Check system for stability.

574090 12/06

53



SAFETY INSTRUCTIONS



FAILURE TO FOLLOW THESE SAFETY INSTRUCTIONS MAY RESULT IN SERIOUS INJURY OR PROPERTY DAMAGE AND WILL VOID WARRANTY.

Owner must ensure that all players know and follow these rules for safe operation of the system.

To ensure safety, do not attempt to assemble this system without following the instructions carefully. Check entire box and inside all packing material for parts and/or additional instruction material. **Before beginning assembly, read the instructions and identify parts using the hardware identifier and parts list in this document.** Proper and complete assembly, use, and supervision are essential for proper operation and to reduce the risk of accident or injury. A high probability of serious injury exists if this system is not installed, maintained, and operated properly.

- If using a ladder during assembly, use extreme caution.
- Two (2) capable adults are recommended for this operation.
- Check base regularly for leakage. Slow leaks could cause system to tip over unexpectedly.
- Seat the pole sections properly (if applicable). Failure to do so could allow the pole sections to separate during play and/or transport of the system.
- Climate, corrosion, or misuse could result in system failure.
- Minimum operational height is 6' 6" (1.98 m) to the bottom of backboard.
- This equipment is intended for home recreational use only and NOT excessive competitive play.
- Read and understand the warning label affixed to pole.
- The life of your basketball pole depends on many conditions. The climate, placement of the pole, location of the pole, exposure to corrosives such as pesticides, herbicides, or salts are all important.
- If technical assistance is required, contact Customer Service.
- Adult supervision is recommended when adjusting height.

*Most injuries are caused by misuse and/or not following instructions.
Use caution when using this system.*



WARNING

Read and understand warnings listed below before using this product.

Failure to follow these warnings may result in serious injury and/or property damage.

Owner must ensure that all players know and follow these rules for safe operation of the system.

- DO NOT HANG on the rim or any part of the system including backboard, support braces or net.
- During play, especially when performing dunk type activities, keep player's face away from the backboard, rim and net. Serious injury could occur if teeth/faces come in contact with backboard, rim or net.
- Do not slide, climb, shake or play on base and/or pole.
- After assembly is complete, fill system completely with water or sand. Never leave system in an upright position without filling base with weight, as system may tip over causing injuries.
- When adjusting height or moving system, keep hands and fingers away from moving parts.
- Do not allow children to move or adjust system.
- During play, do not wear jewelry (rings, watches, necklaces, etc.). Objects may entangle in net.
- Surface beneath the base must be smooth and free of gravel or other sharp objects. Punctures cause leakage and could cause system to tip over.
- Keep organic material away from pole base. Grass, litter, etc. could cause corrosion and/or deterioration.
- Check pole system for signs of corrosion (rust, pitting, chipping) and repaint with exterior enamel paint. If rust has penetrated through the steel anywhere, replace pole immediately.
- Check system before each use for proper ballast, loose hardware, excessive wear and signs of corrosion and repair before use.
- Check system before each use for instability.
- Do not use system during windy and/or severe weather conditions; system may tip over. Place system in the storage position and/or in an area protected from the wind and free from personal property and/or overhead wires.
- Never play on damaged equipment.
- When moving system, use caution to keep mechanism from shifting.
- Keep pole top covered with cap at all times.
- Do not allow water in tank to freeze. During sub-freezing weather add 2 gallons of non-toxic antifreeze, sand or empty tank completely and store. (Do not use salt.)
- While moving system, do not allow anyone to stand or sit on base or have added ballasting on base.
- Do not leave system unsupervised or play on system when wheels are engaged for moving.
- Use Caution when moving system across uneven surfaces. System may tip over.
- Use extreme caution if placing system on sloped surface. System may tip over more easily.
- See instruction manual for proper installation and maintenance.

SPALDING
P.O. Box 1111, 48060-1111
© Spalding 1999

RUSSELL ATHLETIC
P.O. Box 1111, 48060-1111
© Russell Athletic 1999

SURE SHOT
P.O. Box 1111, 48060-1111
© Sure Shot 1999

HYDRA-RIB
P.O. Box 1111, 48060-1111
© Hydra-Rib 1999

HUFFY SPORTS
P.O. Box 1111, 48060-1111
© Huffy Sports 1999



Questions or Missing Parts?

DON'T go back to store!

Call TOLL-FREE Customer Service
Number listed on the front page!

IMPORTANT!

**Remove all contents from boxes.
Be sure to check inside pole sections,
hardware and additional parts are packed inside.**

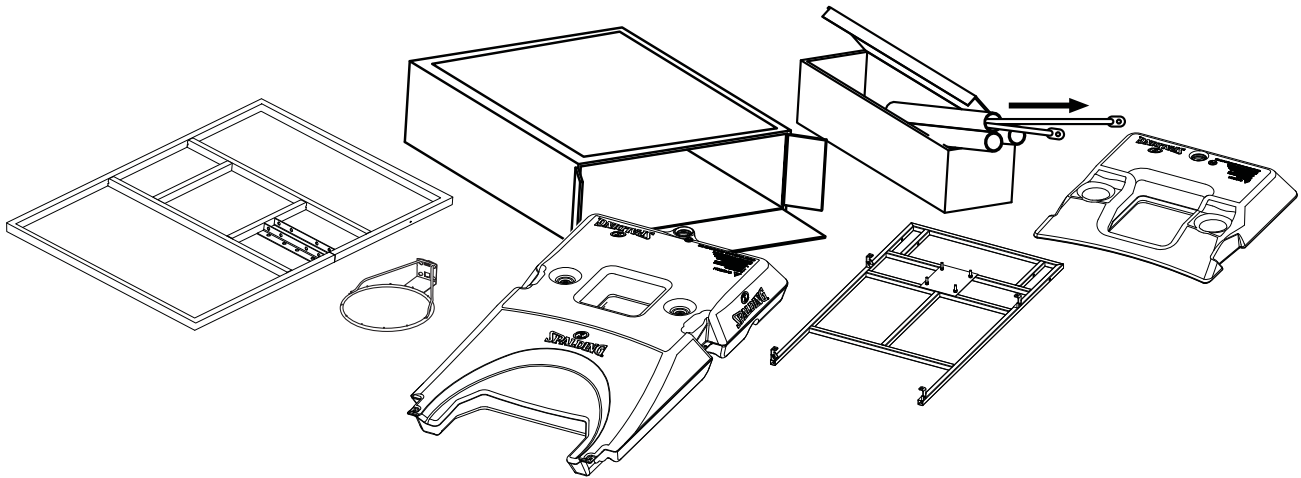

NOTICE TO ASSEMBLERS

Adult Assembly Required. Dispose of ALL packaging materials promptly. As with all products, periodically inspect for loose small parts.

Assembled unit MUST be filled with sand or water at ALL times.

ALL basketball systems, including those used for DISPLAYS, MUST be assembled and installed according to instructions. Failure to follow instructions could result in SERIOUS INJURY. It is NOT acceptable to devise a makeshift support system.



WARNING!



IF YOUR SYSTEM IS EQUIPPED WITH AN ACRYLIC BACKBOARD, EXAMINE BACKBOARD FOR ANY DAMAGE THAT MAY HAVE OCCURRED DURING SHIPMENT. CRACKS IN THE BACKBOARD COULD RESULT IN SUDDEN BREAKAGE. IF BACKBOARD IS DAMAGED IN ANY WAY PRIOR TO OR AFTER ASSEMBLY, CALL TOLL-FREE NUMBER: U.S. 1-800-558-5234; CANADA: 1-800-284-8339; <http://www.spalding.com>

FRONT VIEW

BACK VIEW

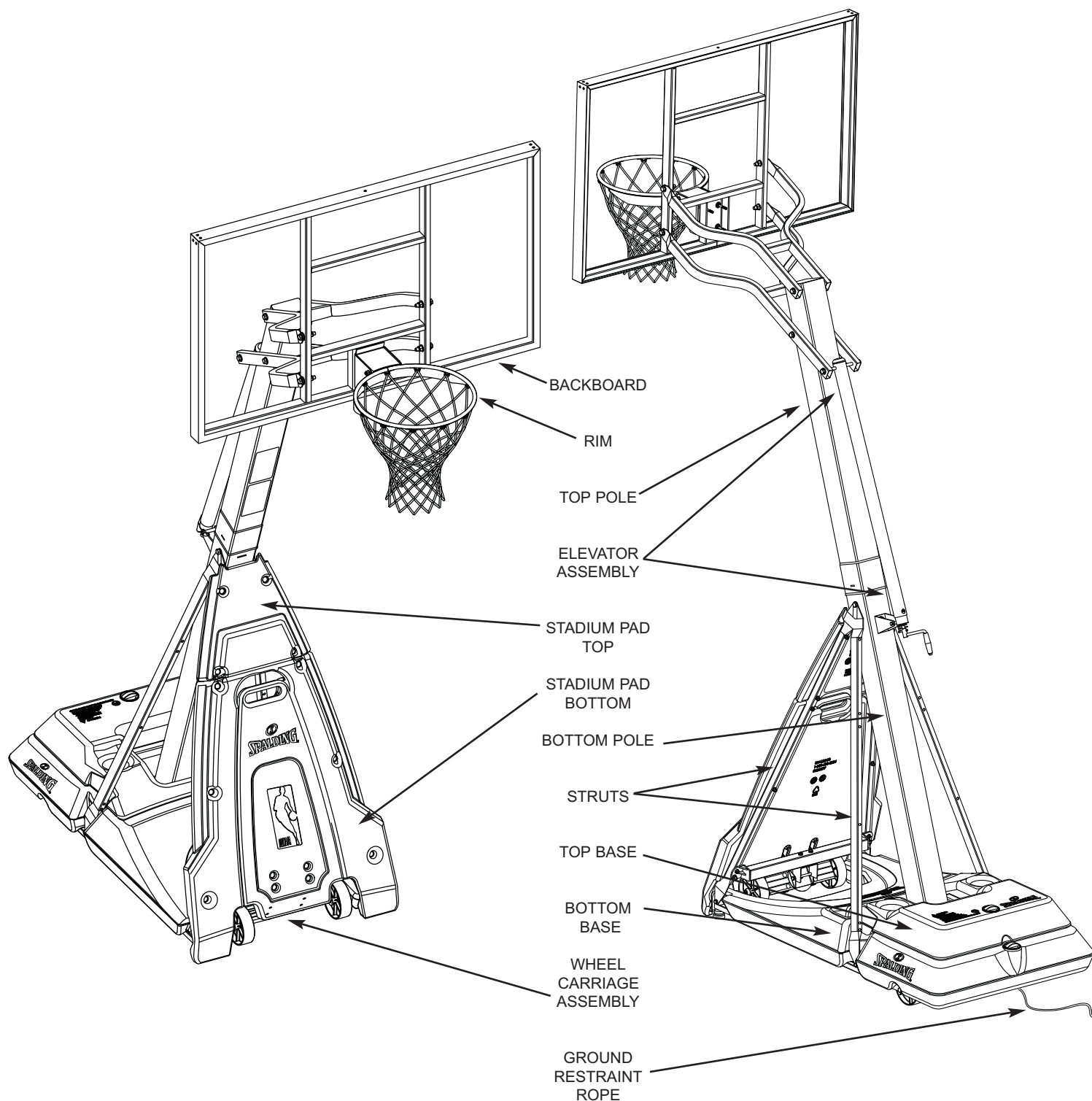

SECTION A: BASE AND POLE ASSEMBLY

BASE TO POLE HARDWARE CARD

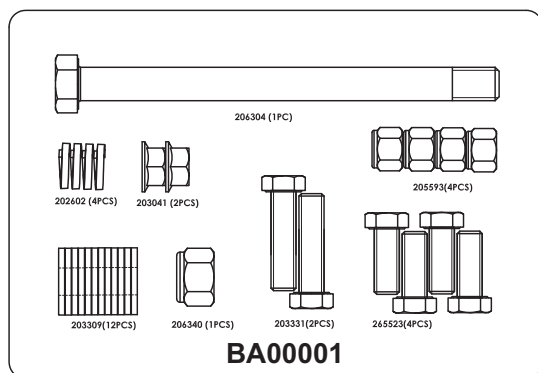

TOOLS REQUIRED FOR THIS SECTION

(2) Wrenches



9/16" 3/4"

AND/OR

(2) Socket Wrenches and Sockets

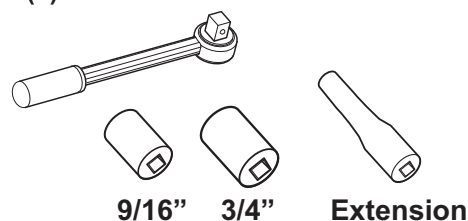

9/16" 3/4" Extension

HARDWARE LIST AND IDENTIFIER

✓ Item Qty. Part No. Description

<input type="checkbox"/>	1	1	600076	Top Base
<input type="checkbox"/>	2	1	FR908622	Bottom Pole Section
<input type="checkbox"/>	3	1	FR908661	Top Pole Section
<input type="checkbox"/>	4	2	908459	Strut, Front, 62.75" Long, with Holes
<input type="checkbox"/>	5	2	908699	Strut, Rear, 62.75" Long
<input type="checkbox"/>	B1	4	265523	Bolt, Hex Head, 3/8-16 x 1" Long
<input type="checkbox"/>	B2	12	203309	Washer, Flat, 3/8 x 1 O.D.

✓ Item Qty. Part No. Description

<input type="checkbox"/>	B3	2	203041	Nut, Hex-Flange, 3/8-16
<input type="checkbox"/>	B4	2	203331	Bolt, Hex Head, 3/8-16 x 1.5" Long
<input type="checkbox"/>	B5	4	205593	Lock-nut, Nylon Insert, 3/8-16
<input type="checkbox"/>	B6	1	206340	Lock-nut, Nylon Insert, 1/2-13
<input type="checkbox"/>	B7	4	202602	Lock-washer, 0.375 I.D. x 0.675 O.D.
<input type="checkbox"/>	B8	1	206304	Bolt, Hex Head, 1/2-13 x 6-5/16" Long

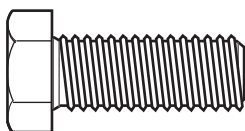

#B1 (4)

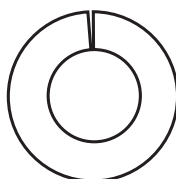

#B2 (12)

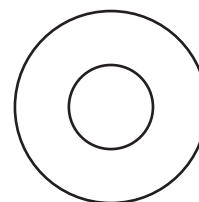

#B2 (12)

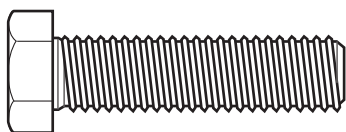

#B4 (2)

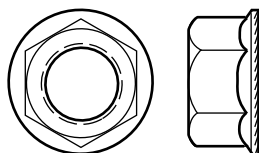

#B3 (2)

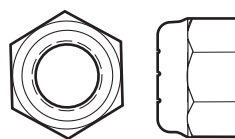

#B5 (4)

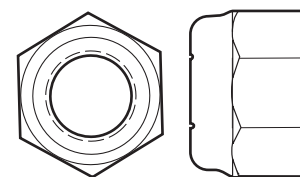

#B6 (1)

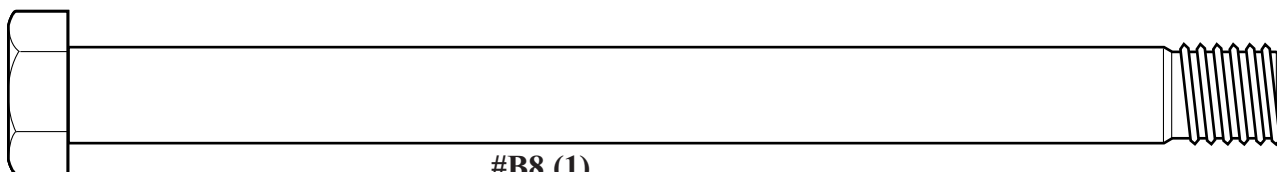

#B8 (1)

1.



WARNING!

PRE-ASSEMBLED COMPONENTS

The components in steps 1 - 3 are factory pre-assembled.

CHECK THE PRE-ASSEMBLED AREAS FOR TIGHTNESS.

If any parts are missing or damaged please contact our customer service department to receive replacement parts (see page 1 for customer service information).

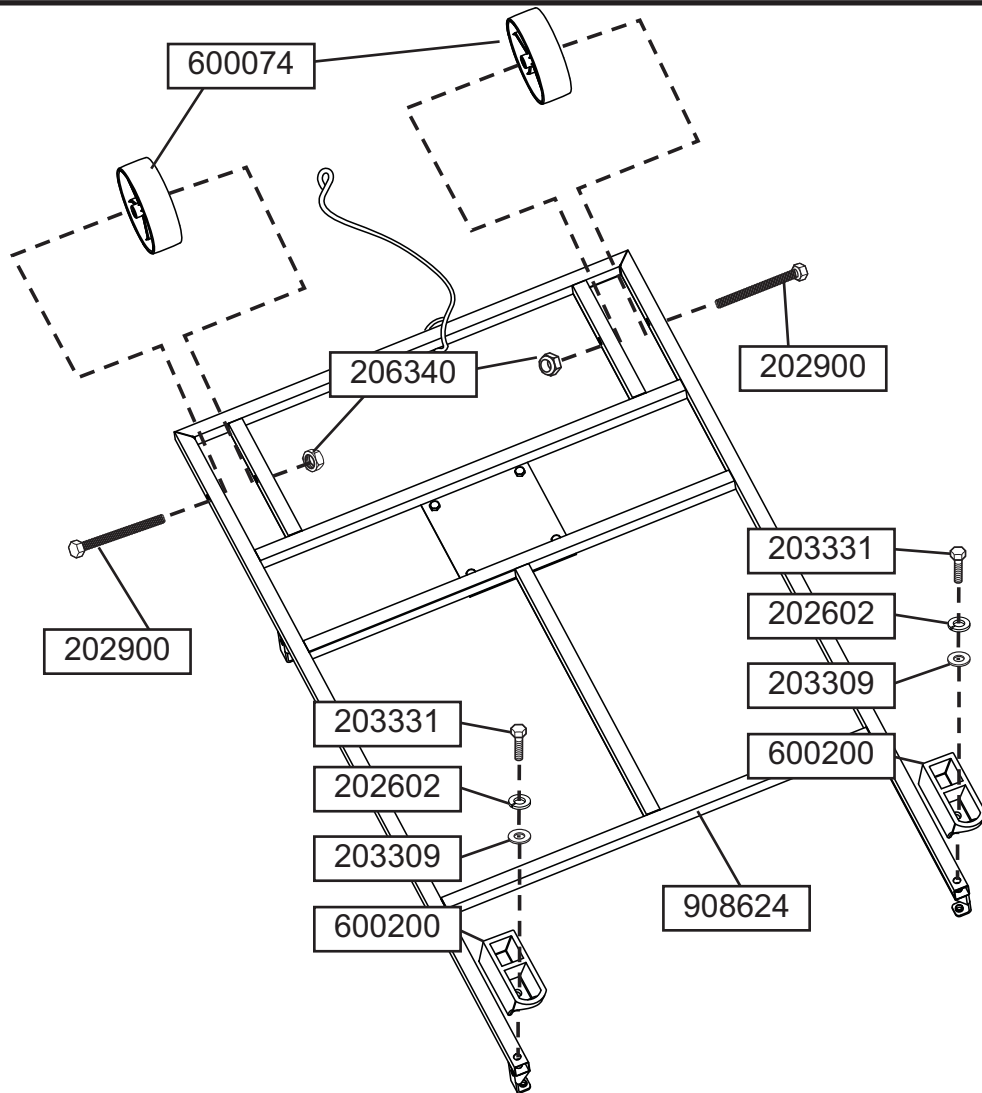

2.

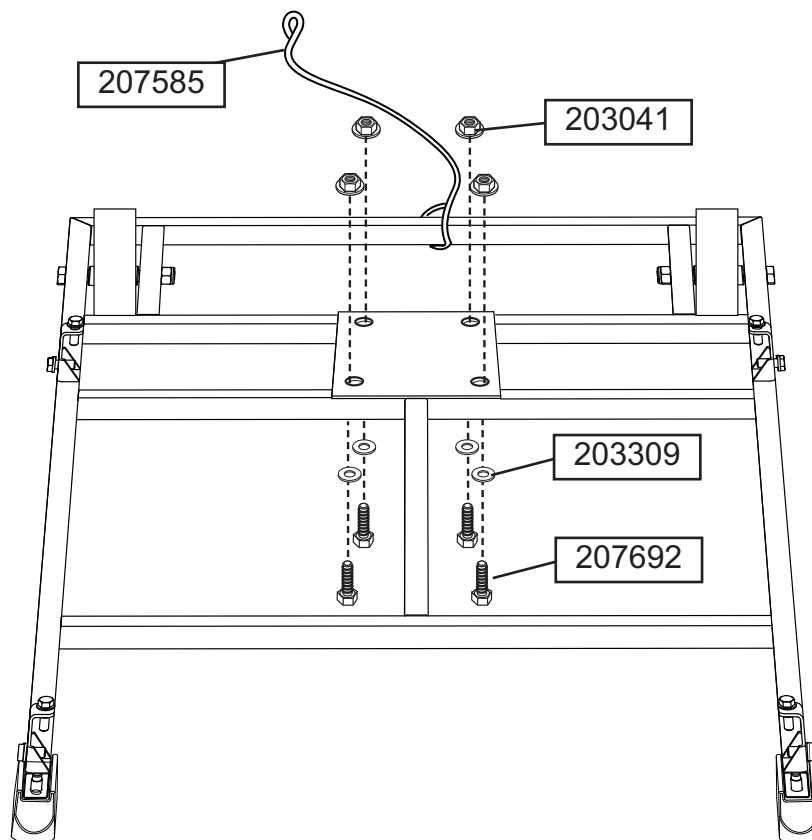

3.

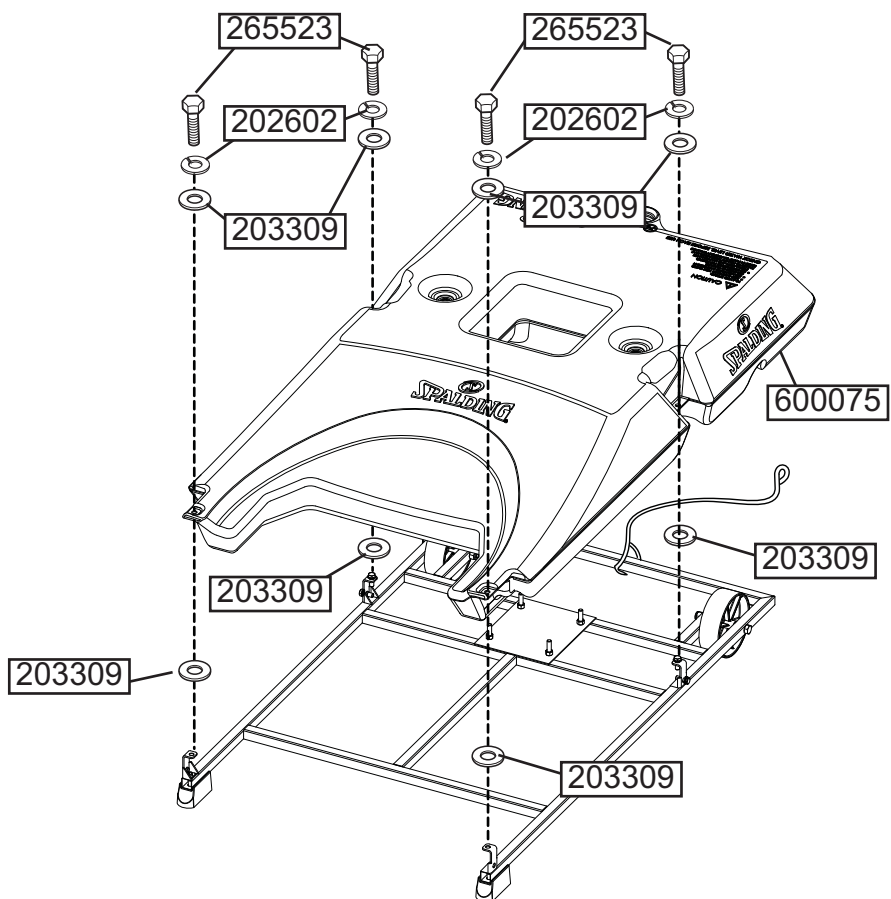

ASSEMBLY REQUIRED

4.

Attach top base (1) to bottom base using bolts (B4), washers (B2) and nuts (B3).

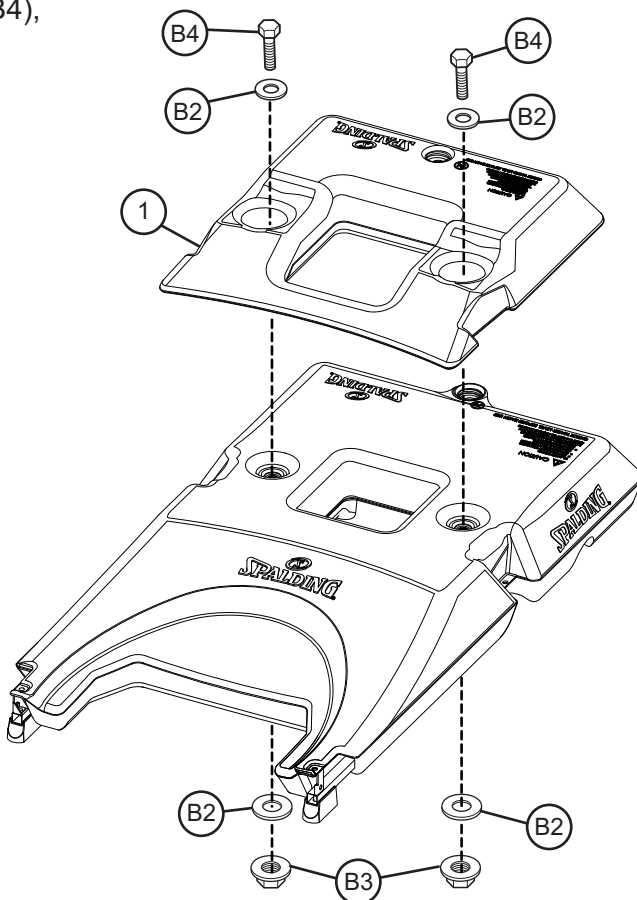

5. Correctly identify each pole section.

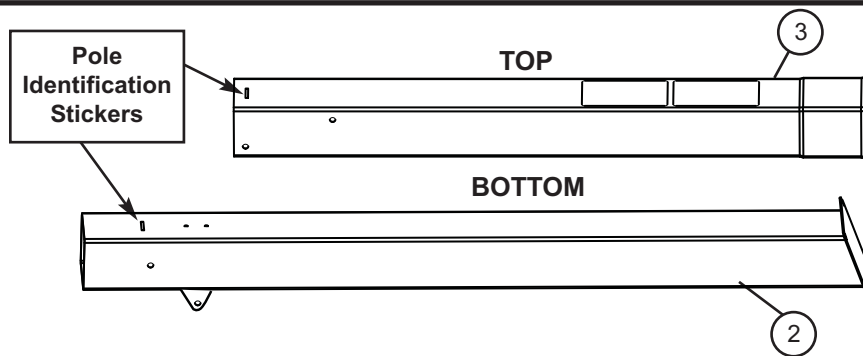

6. While maintaining alignment, bounce bottom pole section (2) into top section (3) using a wood scrap as shown until the top pole no longer moves toward the pole identification sticker on the middle pole.

IMPORTANT!

NOTE ORIENTATION OF EACH POLE SECTION.

Position each pole section so the words "REAR" are aligned on the same side of the pole when assembled.

WARNING!

TWO CAPABLE ADULTS REQUIRED FOR THIS PROCEDURE. FAILURE TO FOLLOW THIS WARNING COULD RESULT IN SERIOUS INJURY AND/OR PROPERTY DAMAGE.

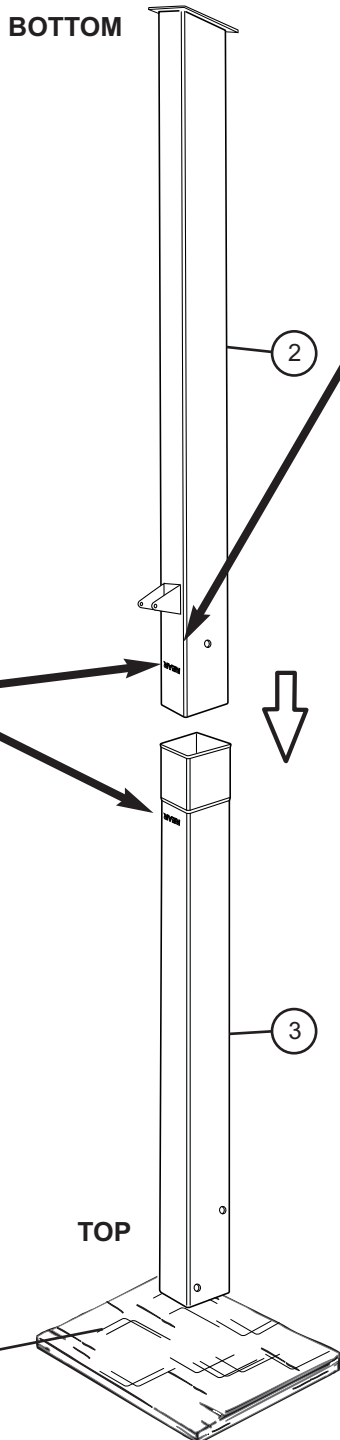

CAUTION!

THE IDENTIFICATION STICKER IS LOCATED 5" FROM THE END OF THE POLE.

WHEN PROPERLY ASSEMBLED, THE POLE SECTIONS SHOULD HAVE A 4" **MINIMUM** OVERLAP, LEAVING 1" BETWEEN THE OVERLAPPING POLE AND THE IDENTIFICATION STICKER.

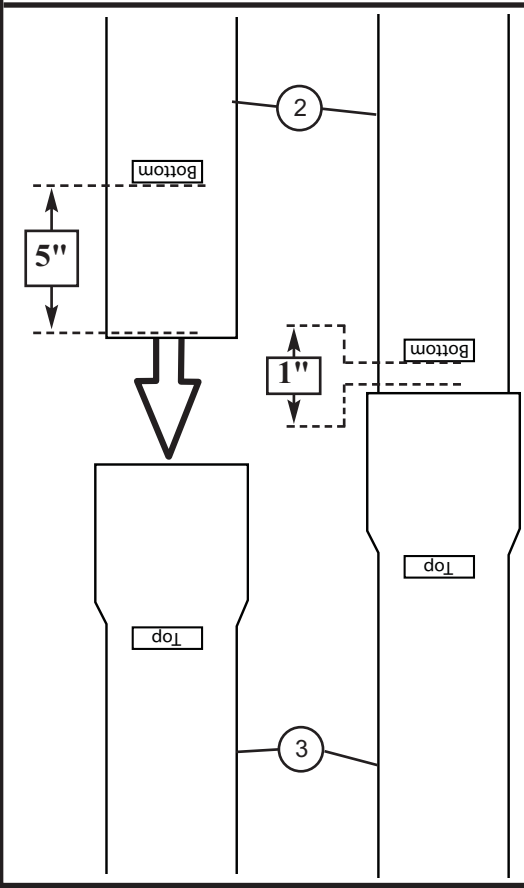

Wood Scrap - 6" x 6" minimum
(NOT SUPPLIED)

7.

Assemble pole to base as shown:

- A. Place 4 washers (B2) onto the 4 pre-installed bolts so they rest on the nuts.
- B. Rest pole on the 4 washers (B2).
Allow 4 pre-attached bolts to pass through the 4 holes in bottom pole flange.
Secure pole assembly to plate with washers (B2) and nuts (B5) as shown.

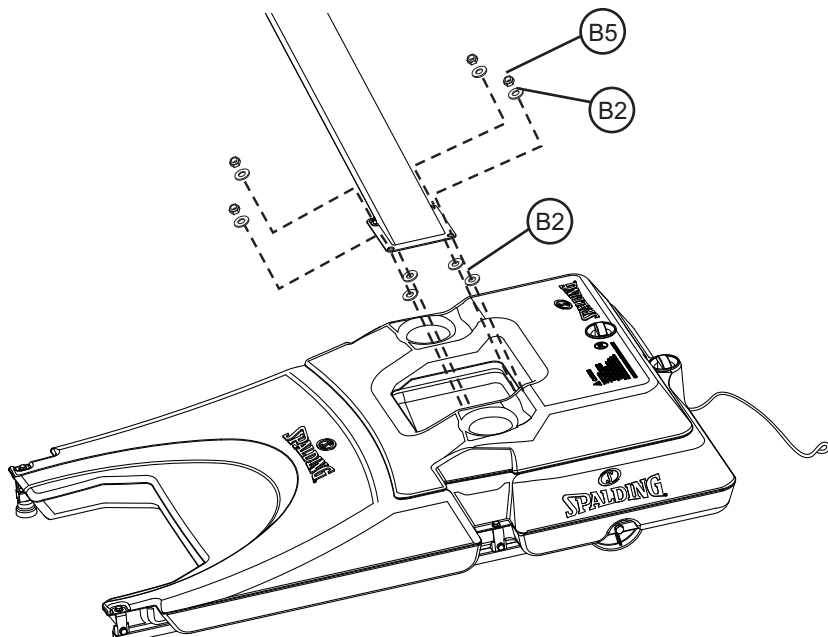

WARNING!



TWO CAPABLE ADULTS REQUIRED FOR THIS PROCEDURE. FAILURE TO FOLLOW THIS WARNING COULD RESULT IN SERIOUS INJURY AND/OR PROPERTY DAMAGE.

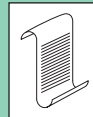

NOTE:

The flange of the bottom pole will rest on the nut and washer of frame plate.

Cutaway Views

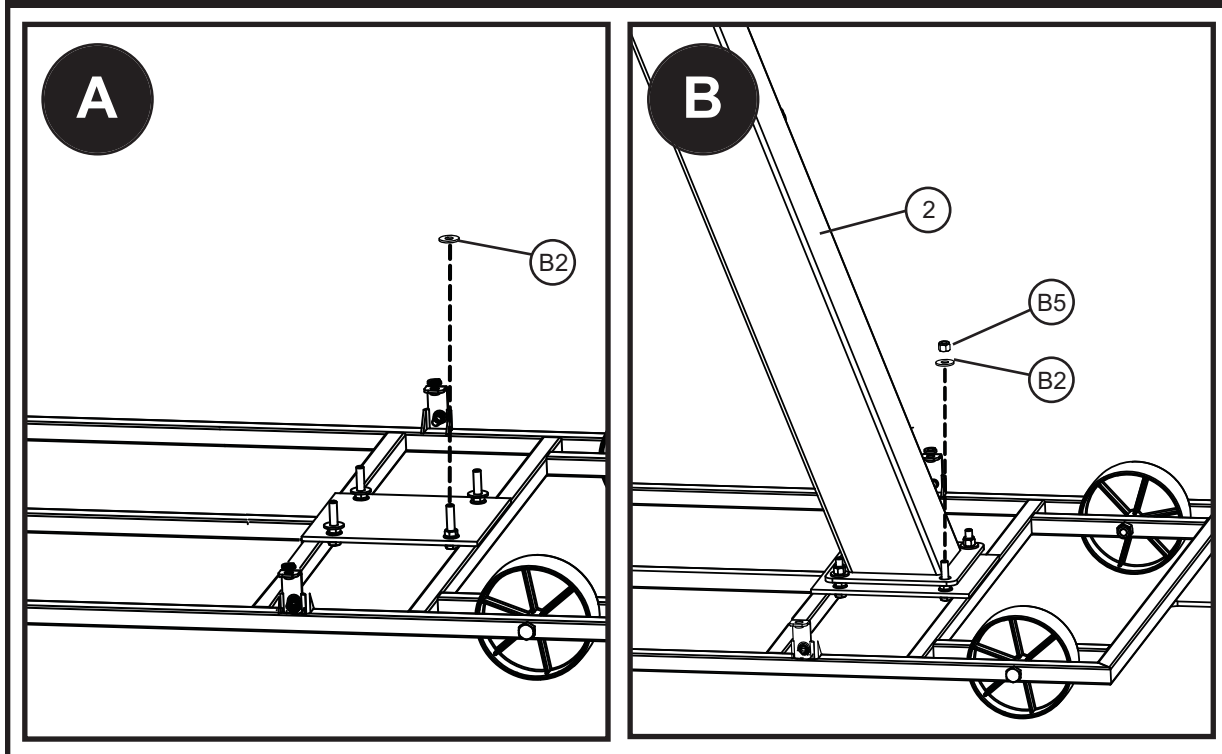

- 8.** Attach struts (4 and 5) to base frame using bolts (B1) and lock washers (B7).

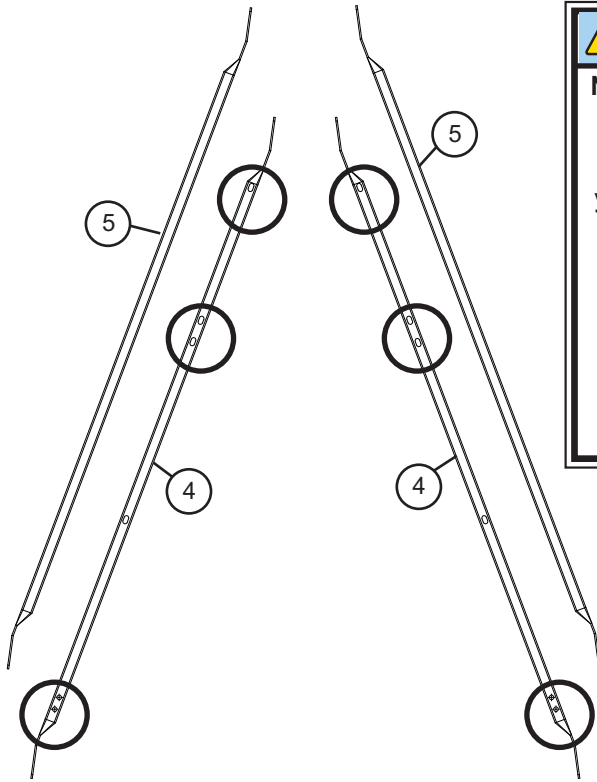

IMPORTANT!

NOTE ORIENTATION OF STRUTS.

Picture shown is as if you are facing the front of the system.

Front struts (4) have holes in them to attach the stadium pad. The rear struts (5) **DO NOT** have the holes.



WARNING!



TWO CAPABLE ADULTS REQUIRED FOR THIS PROCEDURE. FAILURE TO FOLLOW THIS WARNING COULD RESULT IN SERIOUS INJURY AND/OR PROPERTY DAMAGE.

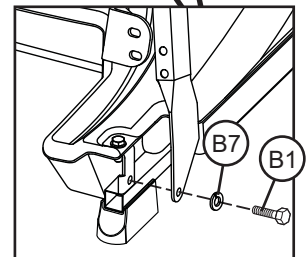
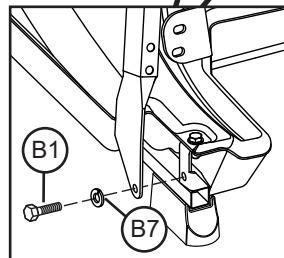
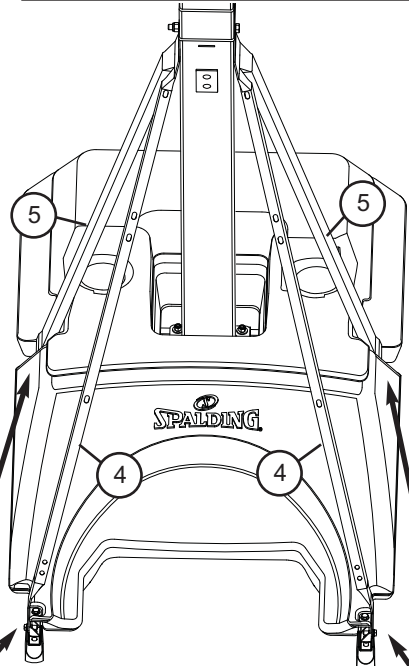

NOTE:

DO NOT fully tighten at this time.

- 9.** Attach struts (4 and 5) to bottom pole (2) using bolt (B8) and nut (B6).



IMPORTANT!

NOTE POSITION OF STRUTS

Front struts, with holes (4), get placed closest to the pole.



NOTE:

Fully tighten all hardware in step 8 and 9 at this time.

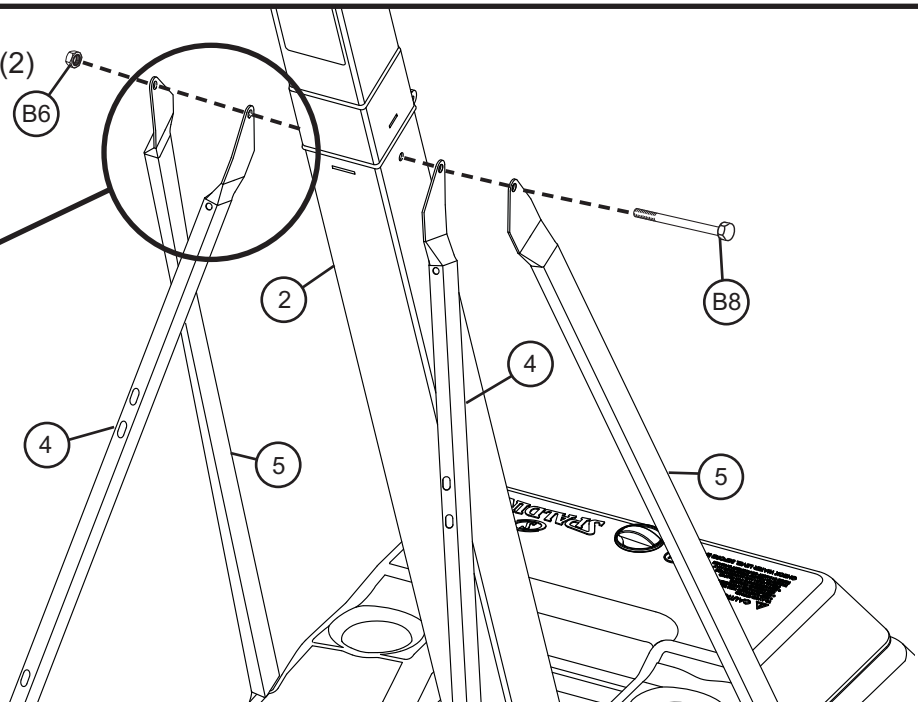

SECTION B: WHEEL CARRIAGE ASSEMBLY

FRONT WHEEL ASSEMBLY HARDWARE CARD

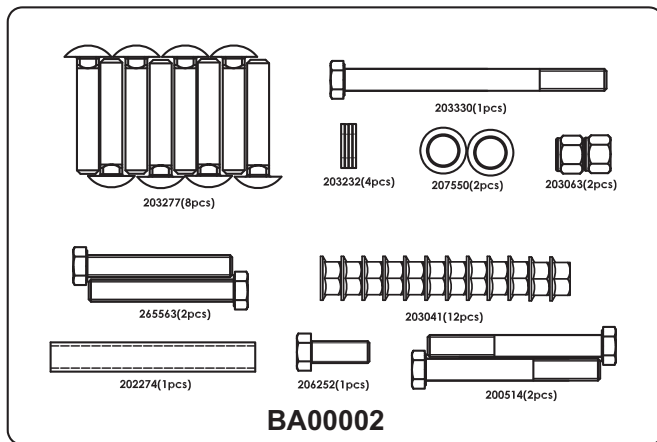

TOOLS REQUIRED FOR THIS SECTION

(2) Wrenches



9/16"

AND/OR

(2) Socket Wrenches and Sockets

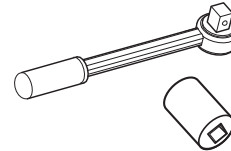

9/16"

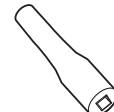

Extension

HARDWARE LIST AND IDENTIFIER

<input checked="" type="checkbox"/> Item	Qty.	Part No.	Description	<input checked="" type="checkbox"/> Item	Qty.	Part No.	Description
<input type="checkbox"/> 10	2	600074	Wheel, 6"	<input type="checkbox"/> W2	12	203041	Nut, Hex-Flange, 3/8-16
<input type="checkbox"/> 11	1	600079	Transport Handle, Plastic	<input type="checkbox"/> W3	4	203232	Washer, Flat
<input type="checkbox"/> 12	1	800373	U-Bracket, Pivot	<input type="checkbox"/> W4	2	265563	Bolt, Hex Head, 3/8-16 x 2.5" Long
<input type="checkbox"/> 13	1	908466	Bracket, Wheel	<input type="checkbox"/> W5	1	203330	Bolt, Hex Head, 3/8-16 x 4.5" Long
<input type="checkbox"/> 14	1	206948	Bracket, Pivot, Lower	<input type="checkbox"/> W6	2	203063	Lock-Nut, 3/8-16
<input type="checkbox"/> 15	1	206956	Disk, Pivot, Plastic	<input type="checkbox"/> W7	1	206252	Bolt, Hex Head, 3/8-16 x 1" Long
<input type="checkbox"/> 16	1	908513	Cross Member	<input type="checkbox"/> W8	8	203277	Bolt, Carriage, 3/8-16 x 2"
<input type="checkbox"/> 17	1	206082	Axle, Rod, 20.5" Long	<input type="checkbox"/> W9	2	207550	Push Caps, Metal,, Wheel Assembly
<input type="checkbox"/> 18	2	908460	Tube, Hinged	<input type="checkbox"/> W10	1	202274	Spacer, 0.379 I.D. x 0.50 O.D. x 3.5" Long
<input type="checkbox"/> W1	2	200514	Bolt, Hex Head, 3/8-16 x 3" Long				

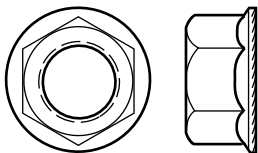

#W2 (12)

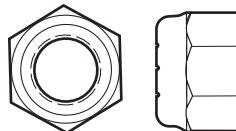

#W6 (2)

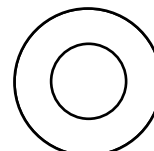

#W3 (4)

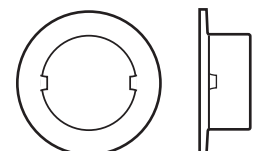

#W9 (2)

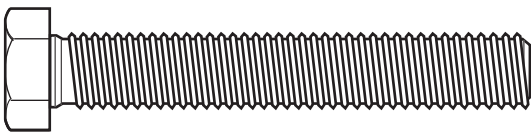

#W4 (2)



#W7 (1)

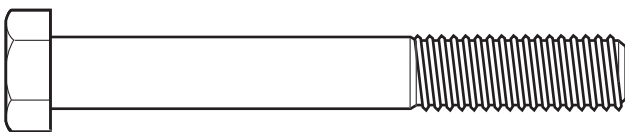

#W1 (2)



#W10 (1)

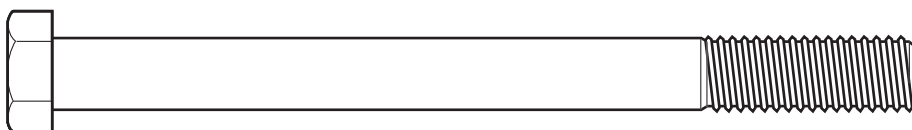

#W5 (1)

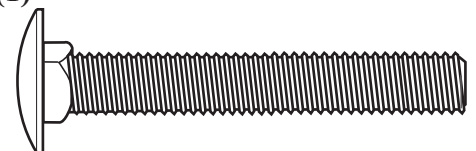

#W8 (8)

1.

A. Attach u-bracket (12) to cross member (16) using bolts (W4), washers (W3) and nuts (W2).

B. Secure cross member (16) to front struts (4) using bolts (W1), washer (W3) and nuts (W2)

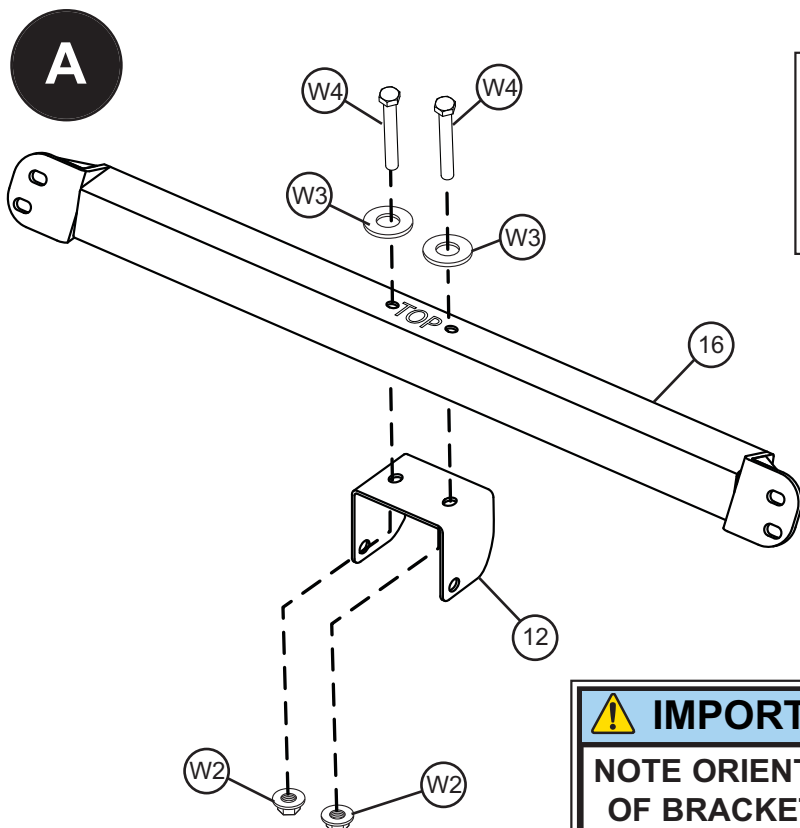

! IMPORTANT!
NOTE ORIENTATION
OF STRUT BRACE (16).

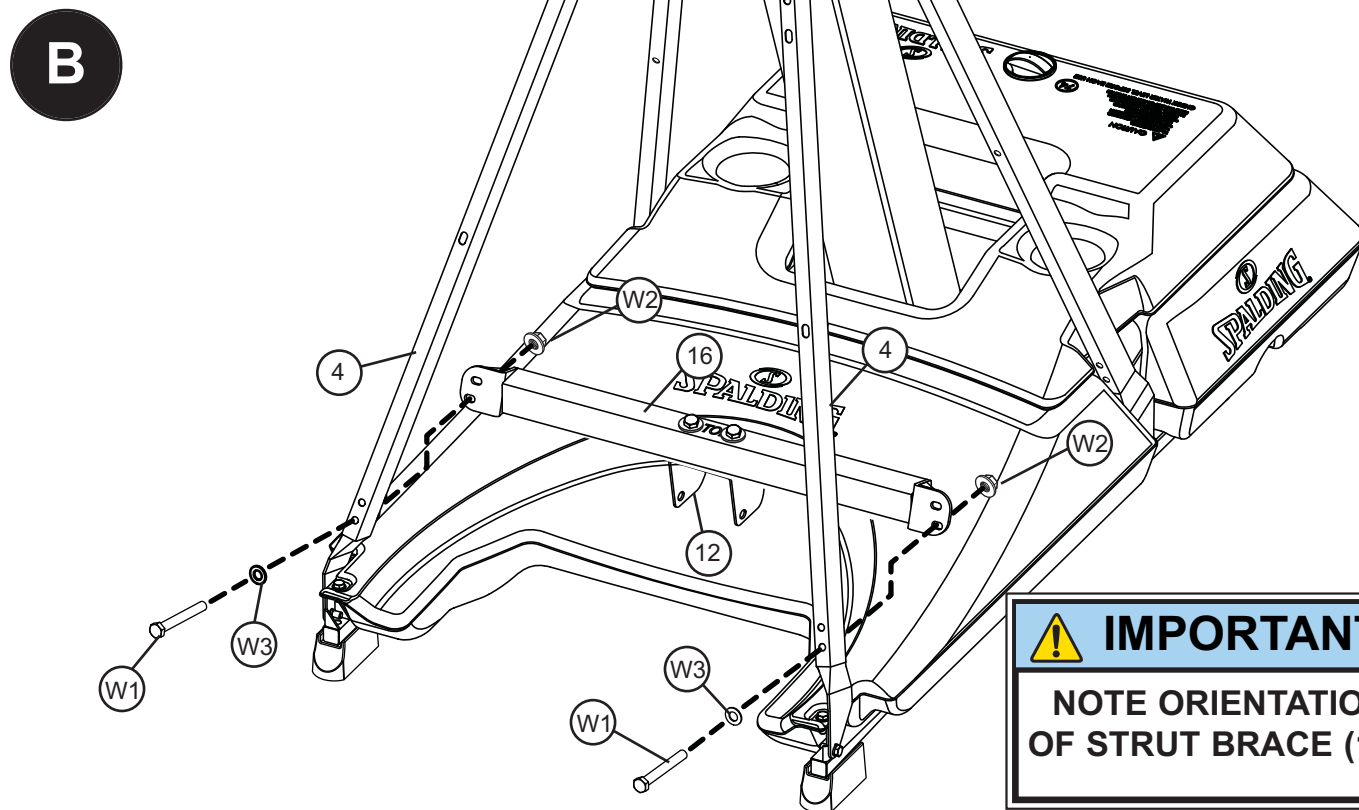
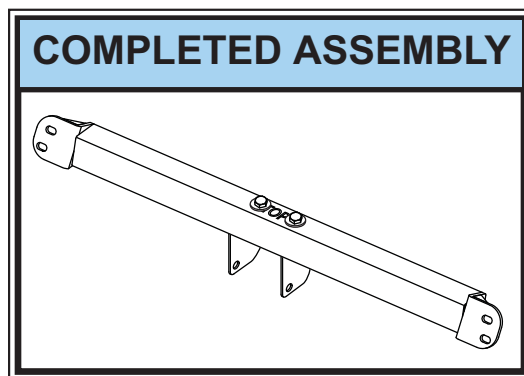

! IMPORTANT!
NOTE ORIENTATION
OF STRUT BRACE (16).

- 2.** Insert axle (17) through wheel bracket (13). Secure wheels (10) to axle using pushnuts (W9). Carefully tap pushnuts (W9) onto axle with hammer or mallet.

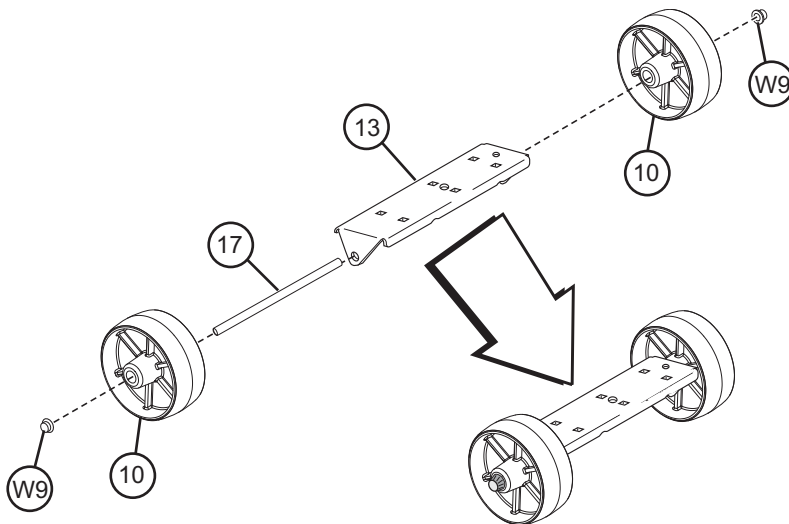
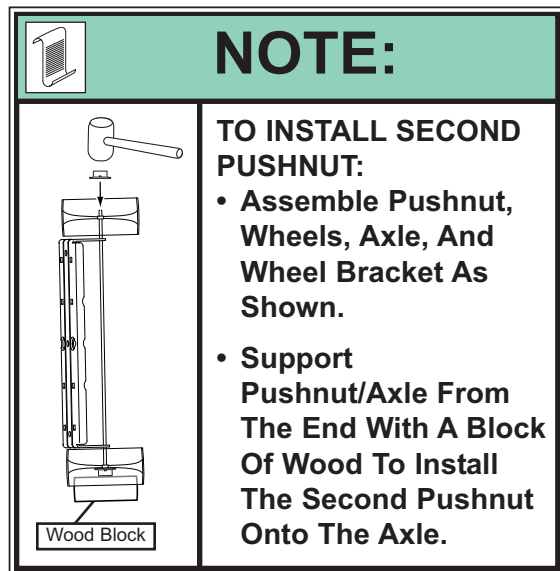

- 3.** Secure hinge tubes (18) to wheel bracket (13) using bolts (W8), and nuts (W2).

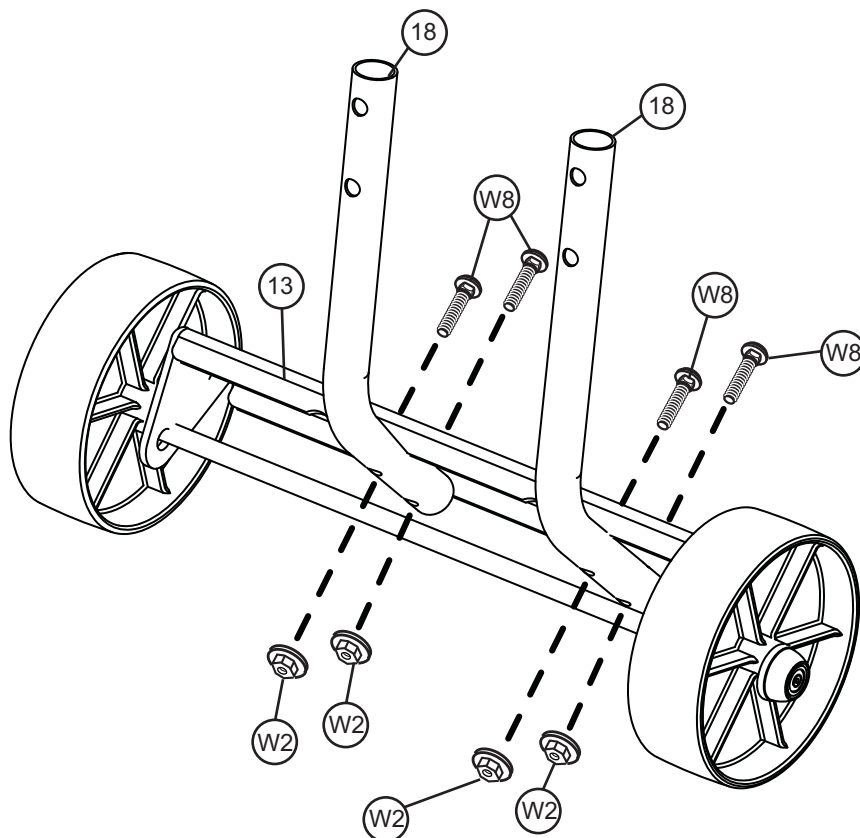
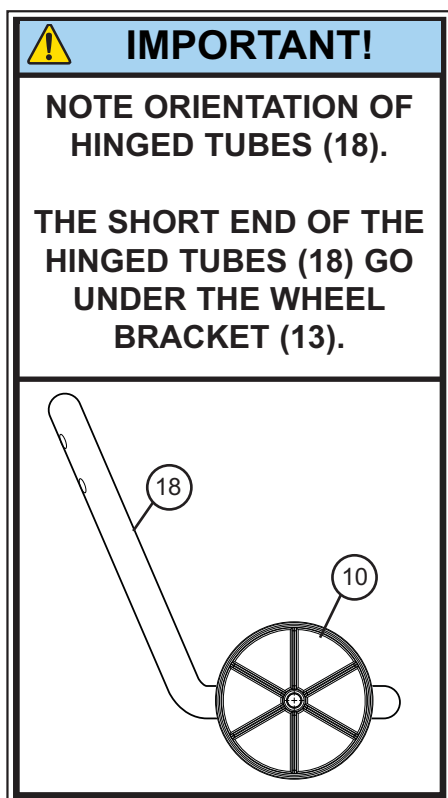

- 4.** Secure lower pivot bracket (14) to wheel assembly using bolt (W7), pivot disk (15), lower pivot bracket (14) and nut (W6). Secure wheel assembly to u-bracket (12) using bolt (W5), spacer (W10), and nut (W6).

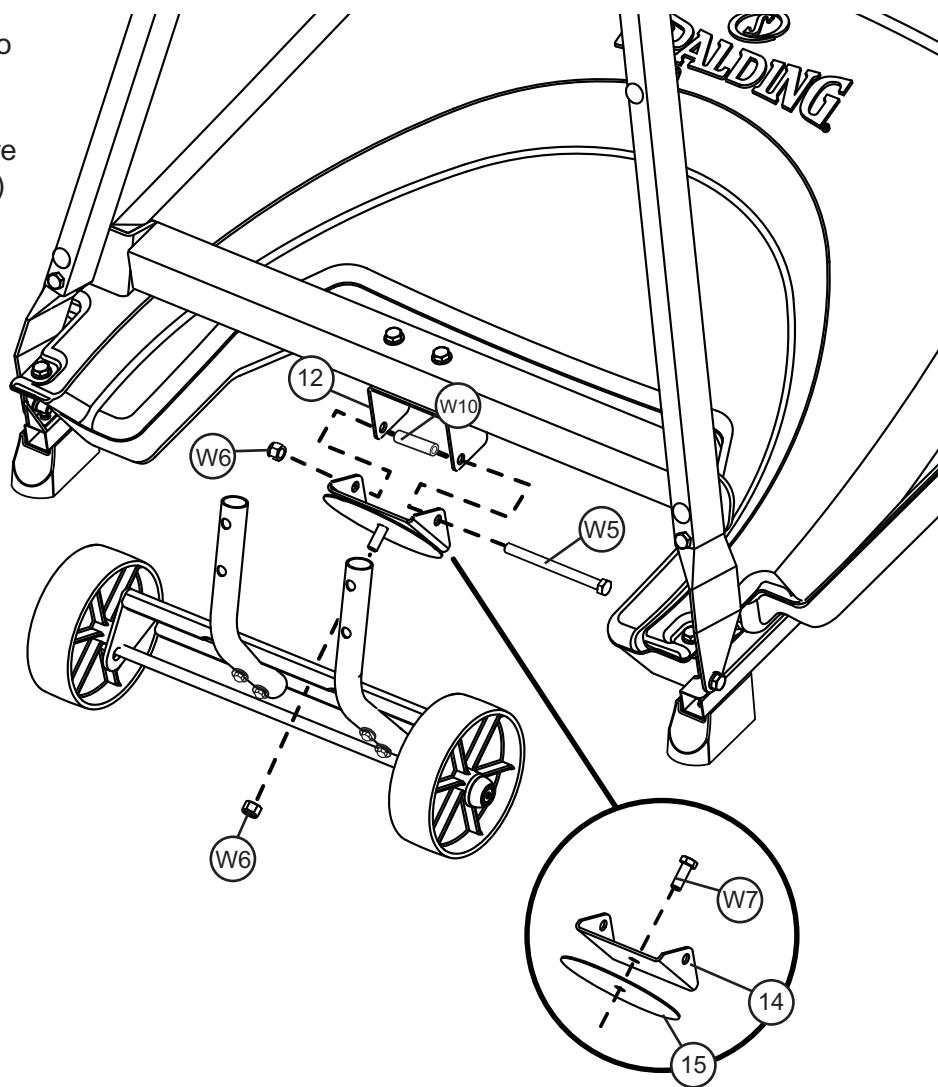
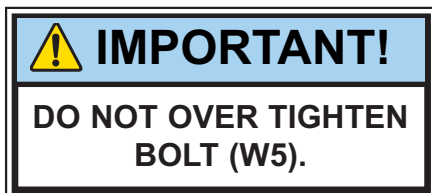

- 5.** Attach transport handle (11) to wheel assembly using carriage bolts (W8) and nuts (W2).

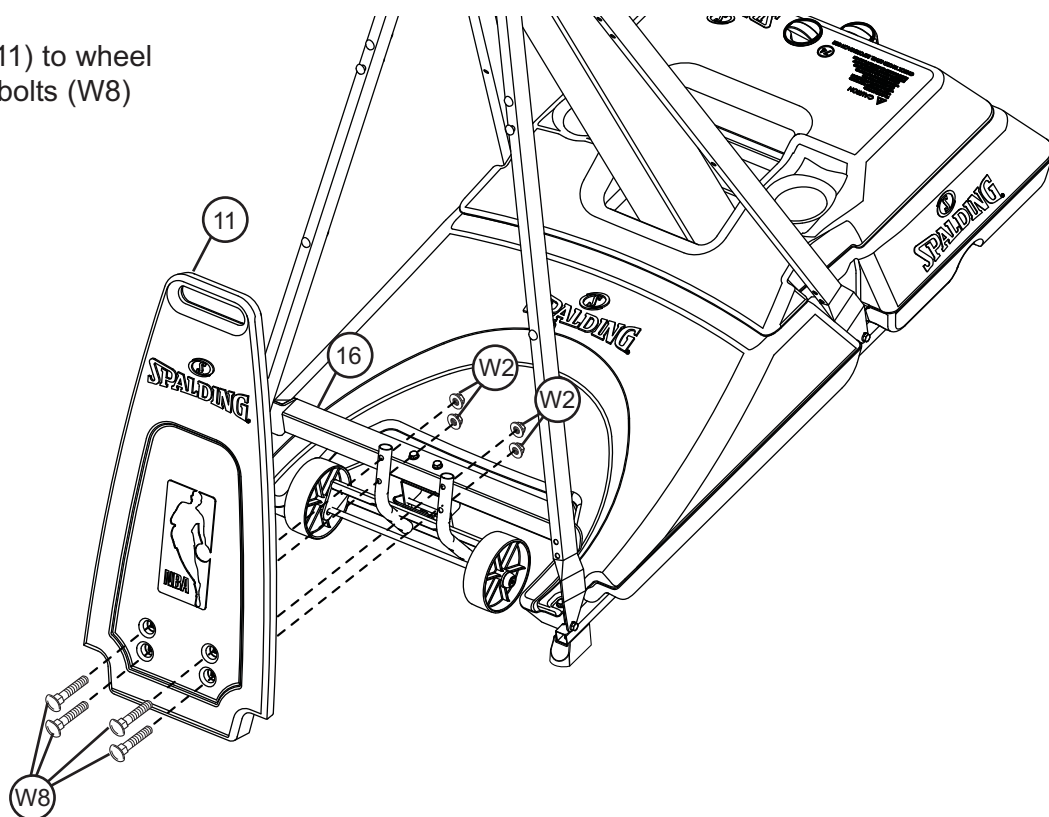

SECTION C: ELEVATOR ASSEMBLY PART 1

ELEVATOR TO POLE CONNECTION HARDWARE CARD

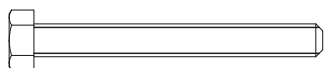

201518(1pcs)



203099(1pcs)

EL00001

TOOLS REQUIRED FOR THIS SECTION

(2) Wrenches



1/2"

(2) Socket Wrenches
and Sockets

AND/OR

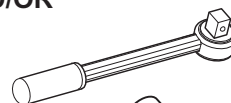

1/2"

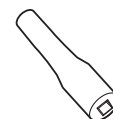

Extension

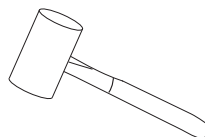

Hammer or
Mallet

HARDWARE LIST AND IDENTIFIER

☒ Item Qty. Part No. Description

<input type="checkbox"/> 20	1	700009	Handle, Screw-Jack
<input type="checkbox"/> 21	1	800972	Screw Jack
<input type="checkbox"/> 22	1	600199	Sleeve, Screw Jack
<input type="checkbox"/> 23	1	600165	Cap, Screw Jack

☒ Item Qty. Part No. Description

<input type="checkbox"/> 24	1	202528	Pin, Handle
<input type="checkbox"/> E1	1	201518	Bolt, Hex-Head, 5/16-18 x 2.75" Long
<input type="checkbox"/> E2	1	203099	Lock-Nut, Nylon Insert, 5/16-18

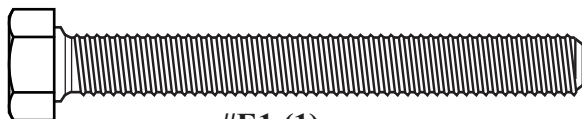

#E1 (1)

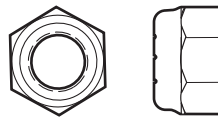

#E2 (1)

1.

A. Securely rest the assembly on sawhorse.

B. Slide screw-jack sleeve (22) over screw jack and attach cap (23) to top end.

C. Attach screw-jack (21, 22, 23) to pole bracket with bolt (E1) and nut (E2) as shown.

D. Attach handle (20) to screw jack with pin (24).

A

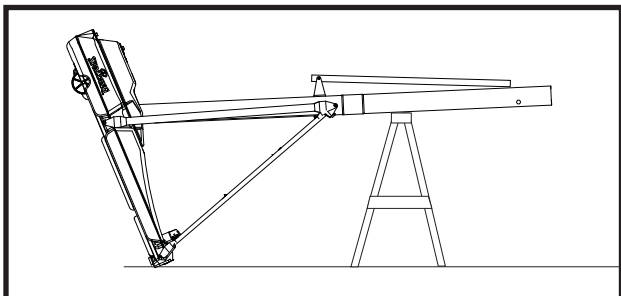

B

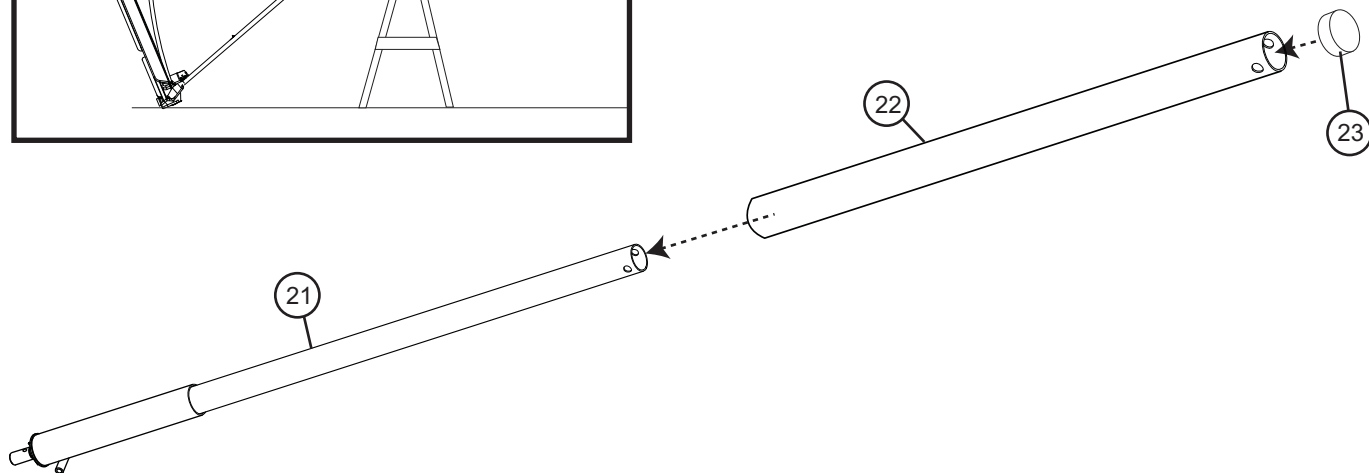

C

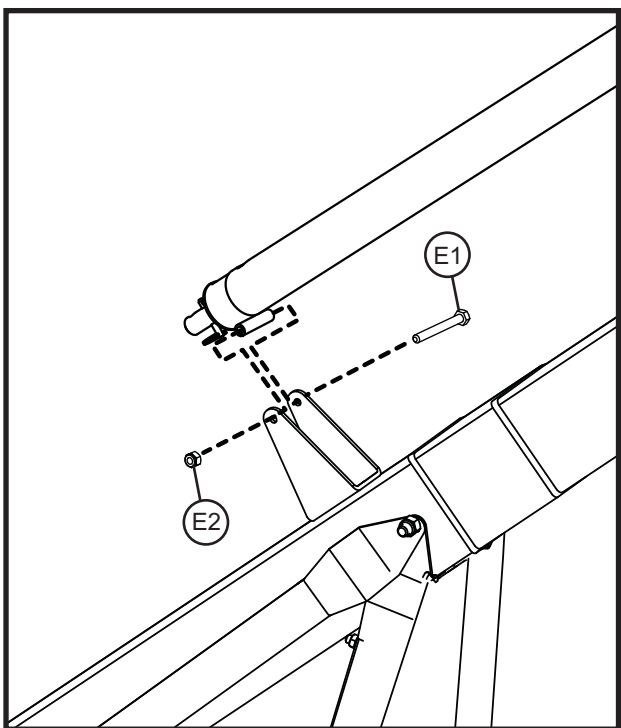

D

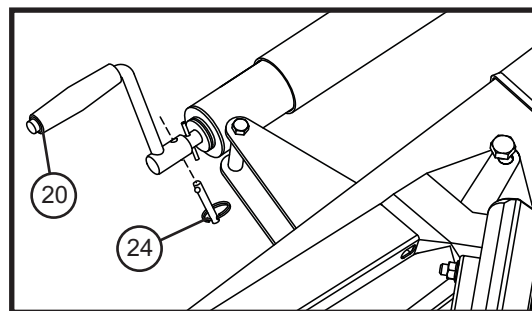

SECTION D: ELEVATOR ASSEMBLY PART 2

TOOLS REQUIRED FOR THIS SECTION

ELEVATOR ARMS HARDWARE CARD

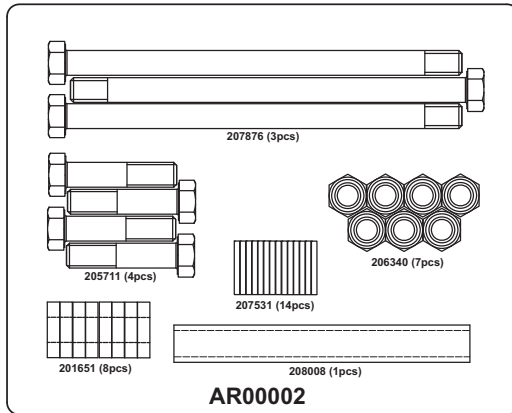

(2) Wrenches



3/4"

AND/OR

(2) Socket Wrenches and Sockets

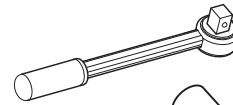

3/4"



Extension

HARDWARE LIST AND IDENTIFIER

☒ Item Qty. Part No. Description

<input type="checkbox"/> 30	1	908508	Elevator Tube, Upper
<input type="checkbox"/> 31	1	908509	Elevator Tube, Lower
<input type="checkbox"/> 32	1		Backboard
<input type="checkbox"/> 33	2	700012	Plug Cap
<input type="checkbox"/> A1	4	205711	Bolt, Hex-Head, 1/2-13 x 2.25" Long

☒ Item Qty. Part No. Description

<input type="checkbox"/> A2	7	206340	Nut, Nylock, 1/2-13
<input type="checkbox"/> A3	14	207531	Washer, Flat, 1.08" O.D.
<input type="checkbox"/> A4	8	201651	Bushing, Plastic, 1.13" O.D.
<input type="checkbox"/> A5	3	207876	Bolt, Hex-Head, 1/2-13 x 8.4" Long
<input type="checkbox"/> A6	1	208008	Spacer, Metal, 0.53" I.D. x 0.75 O.D. x 5.125" Long

#A5 (3)

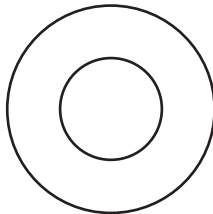

#A3 (14)

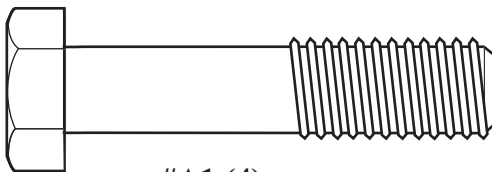

#A1 (4)

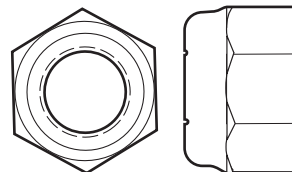

#A2 (7)

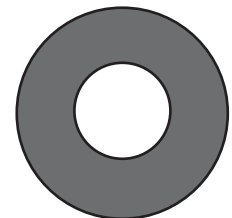

#A4 (8)

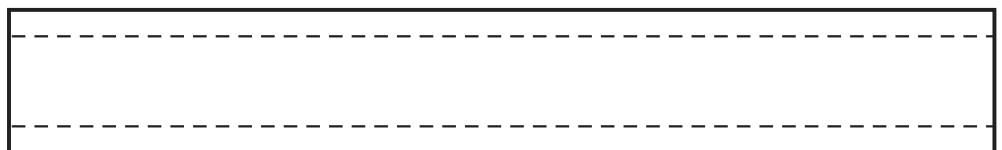
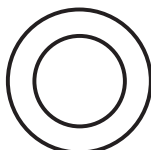

#A6 (1)

- 1.** While system is still resting on sawhorse, Identify elevator tubes (30 and 31).

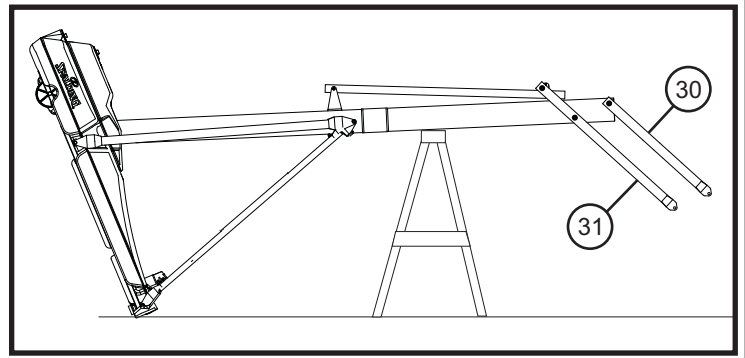
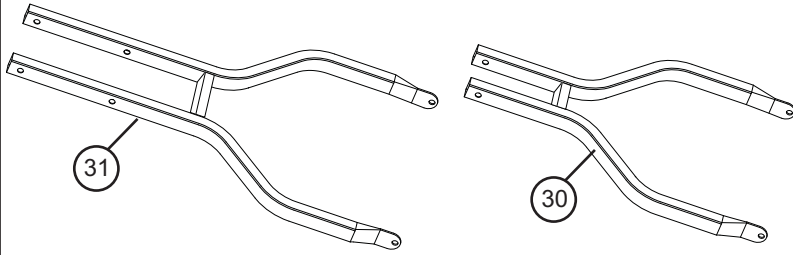

- 2.** While the system is securely resting on the sawhorse. Install elevator tubes (30 and 31) to top pole section (3) as shown.

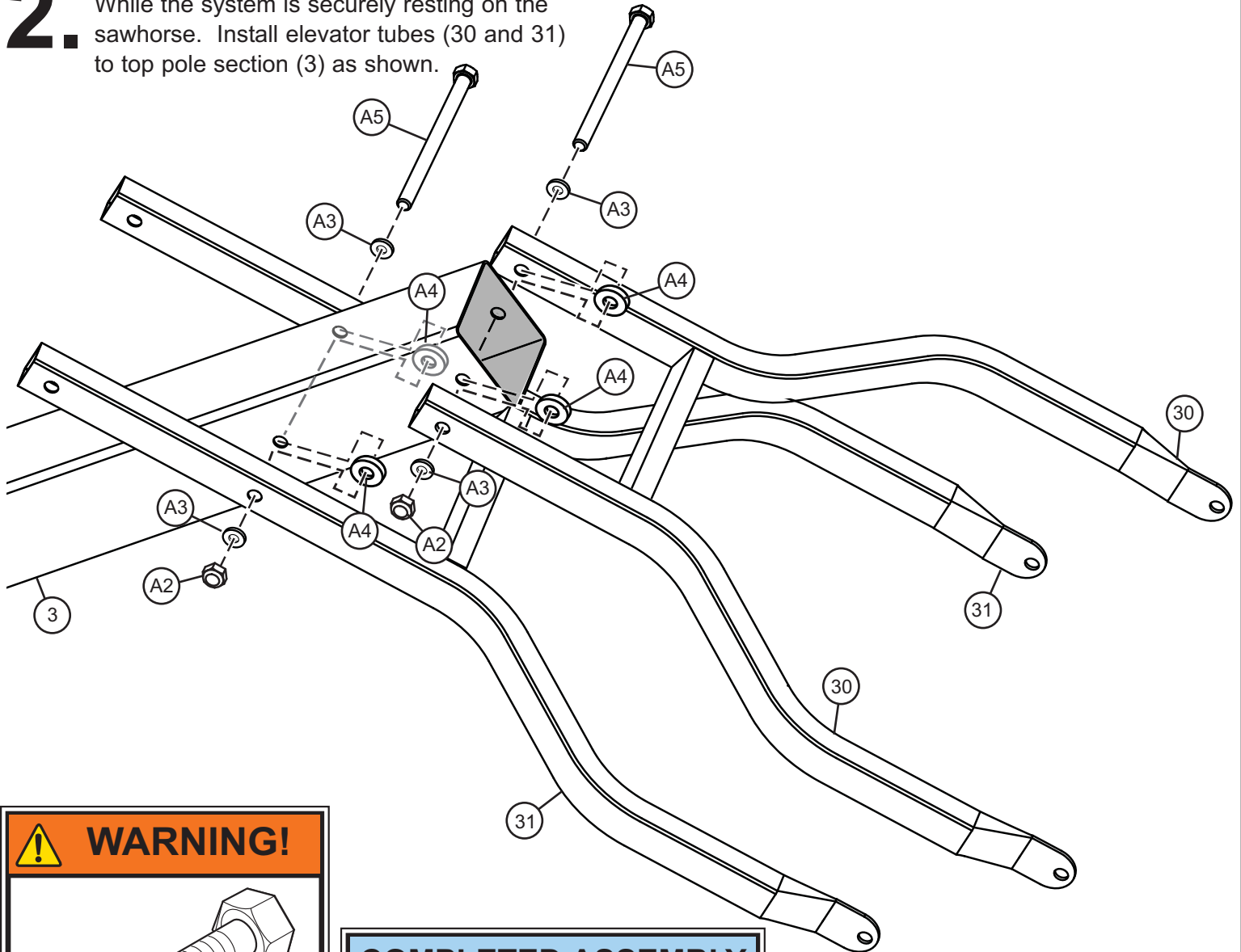

WARNING!

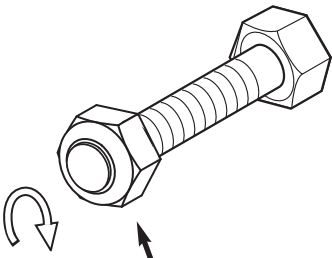

TIGHTEN BOLT (A5) IN
LOCK NUT (A2) UNTIL
FLUSH (EVEN) WITH LOCK
NUT'S OUTER EDGE.

COMPLETED ASSEMBLY

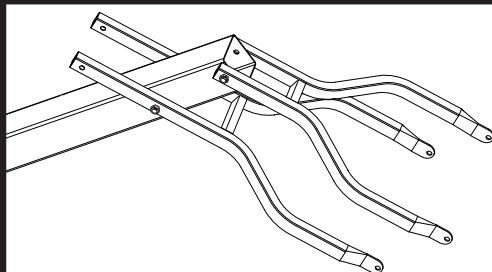

WARNING!



TWO CAPABLE ADULTS
REQUIRED FOR THIS
PROCEDURE. FAILURE TO
FOLLOW THIS WARNING COULD
RESULT IN SERIOUS INJURY
AND/OR PROPERTY DAMAGE.

- 3.** While the system is still resting on the sawhorse, install screw jack assembly to lower elevator tube (31). Secure with bolt (A5), washers (A3), spacer (A6) and nut (A2).

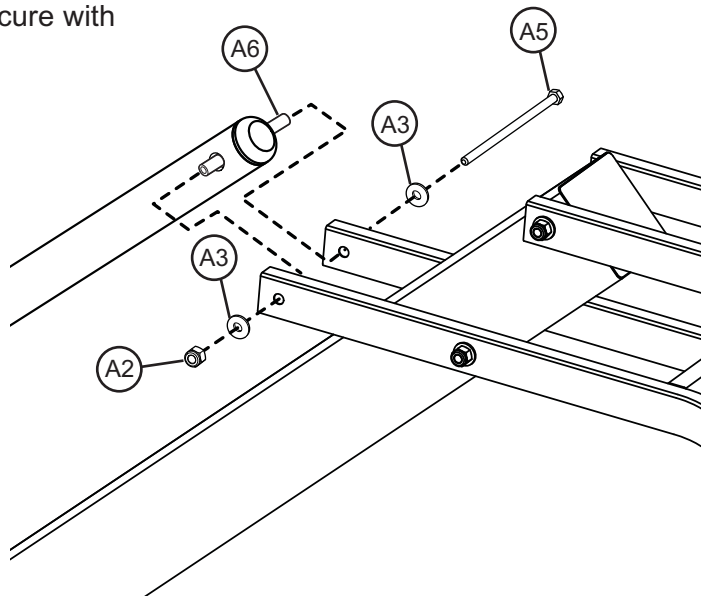
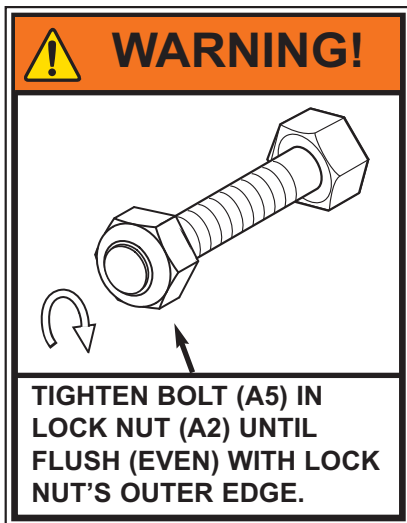

- 4.** Attach backboard (32) to elevator tubes (30, 31) as shown.

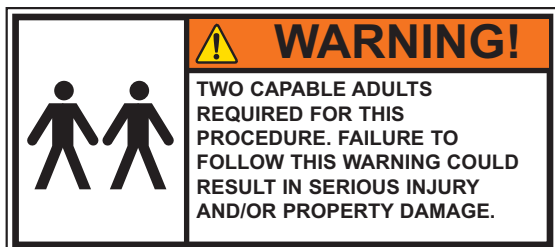
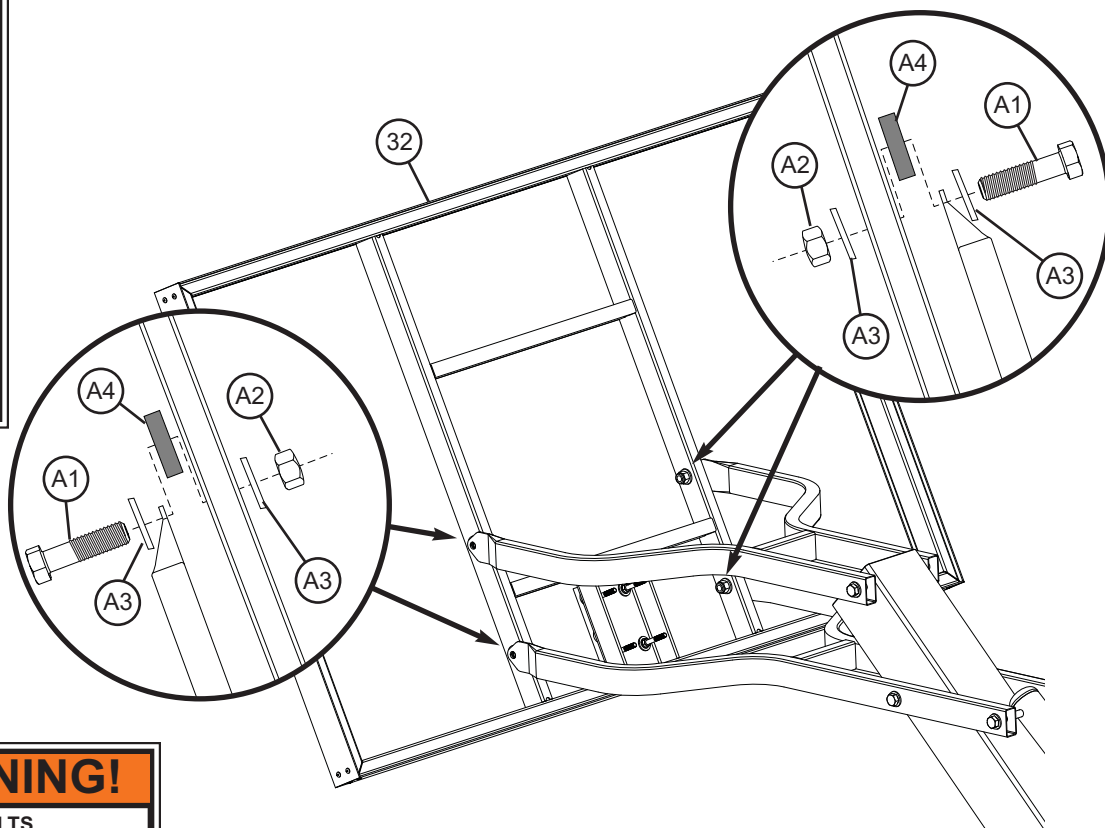
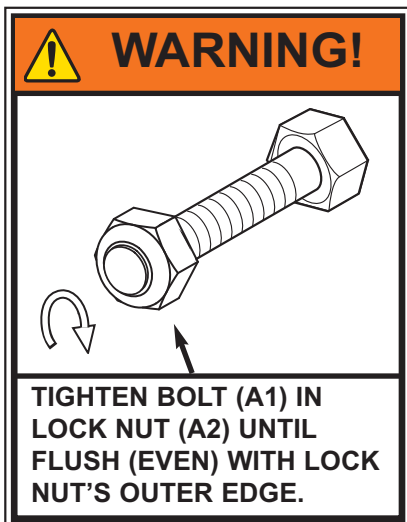

- 5.** A. Fill bottom base half-way with water (approx. 25 gallons (95 Liters)) or sand (approx. 295 of total 590 lbs. (134 of total 268 kg)).
- B. Set backboard to the LOWEST elevator setting
- C. **CAREFULLY** upright system.

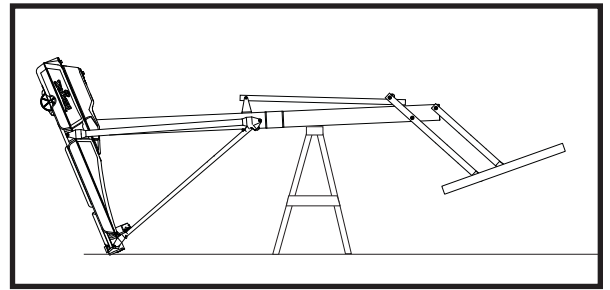

NOTE:

Make sure that the anchor rope is centered.



WARNING!	
	<p>TWO CAPABLE ADULTS REQUIRED FOR THIS PROCEDURE. FAILURE TO FOLLOW THIS WARNING COULD RESULT IN SERIOUS INJURY AND/OR PROPERTY DAMAGE.</p>
	<p>DO NOT LEAVE ASSEMBLY UNATTENDED WHEN EMPTY; IT MAY TIP OVER.</p>
CAUTION!	
	<p>ADD TWO GALLONS (7.6 LITERS) OF NON-TOXIC ANTIFREEZE IN <u>BOTTOM</u> BASE FOR SUB-FREEZING CLIMATES.</p>
	<p><u>IF USING SAND:</u> 2 GALLONS OF ANTI-FREEZE IS <u>NOT</u> REQUIRED.</p>

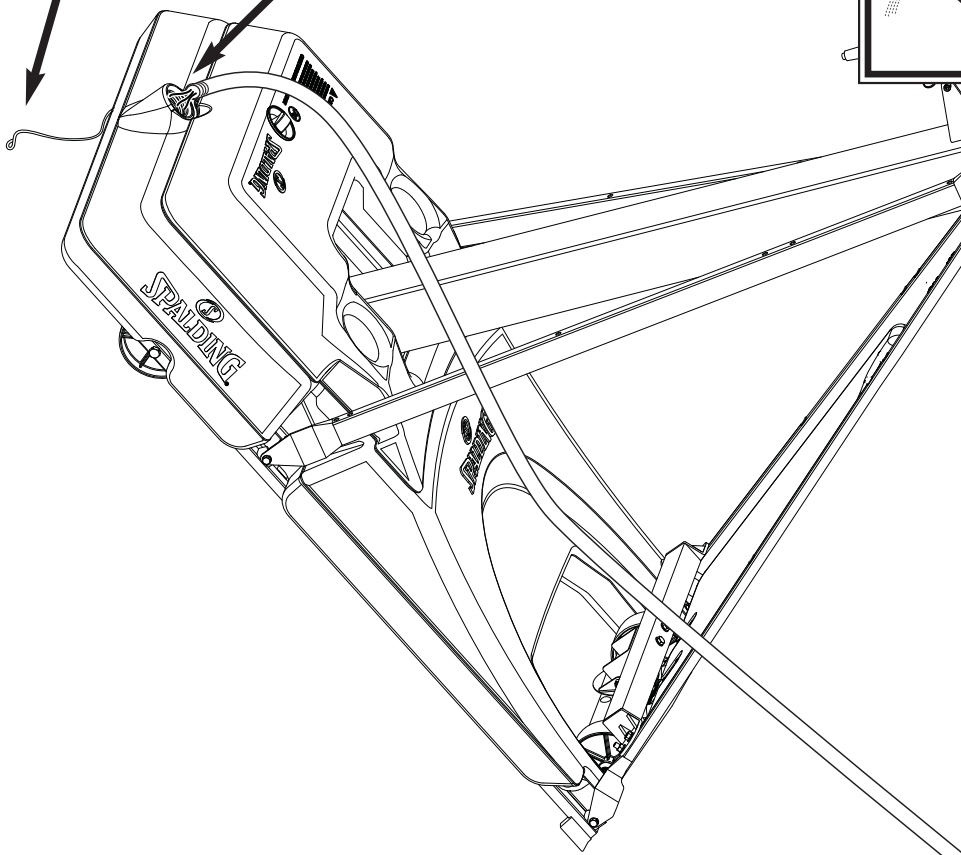

6. Roll completed assembly to desired position.

After system is placed in an upright position, **COMPLETE** the filling process in **BOTH** bases.

If using **WATER**, the total amounts are as follows:

Top Base: approx. 9.8 gallons (37.1 liters)

Bottom Base: approx. 49 gallons (186 liters)

If using **SAND**, the total amounts are as follows:

Top Base: approx. 117 lbs. (53.1 kg)

Bottom Base: approx. 590 lbs. (268 kg)

Rotate caps (33) securely into **BOTH** bases.

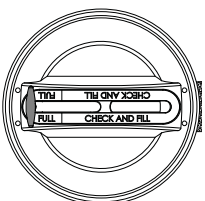
WARNING!	
 	<p>Cap (33) MUST be tightened COMPLETELY and SECURELY to prevent leakage.</p> <p>CHECK WATER LEVEL BEFORE EACH USE! FAILURE TO FOLLOW THIS WARNING COULD RESULT IN SERIOUS INJURY AND/OR PROPERTY DAMAGE.</p>

WARNING!	
 	<p>TWO CAPABLE ADULTS REQUIRED FOR THIS PROCEDURE. FAILURE TO FOLLOW THIS WARNING COULD RESULT IN SERIOUS INJURY AND/OR PROPERTY DAMAGE.</p>
	<p>DO NOT LEAVE ASSEMBLY UNATTENDED WHEN EMPTY; IT MAY TIP OVER.</p>
CAUTION!	
 	<p>ADD ONE GALLONS (7.6 LITERS) OF NON-TOXIC ANTIFREEZE IN <u>TOP</u> BASE FOR SUB-FREEZING CLIMATES.</p> <p><i>IF USING SAND:</i> 2 GALLONS OF ANTI-FREEZE IS <u>NOT</u> REQUIRED.</p>

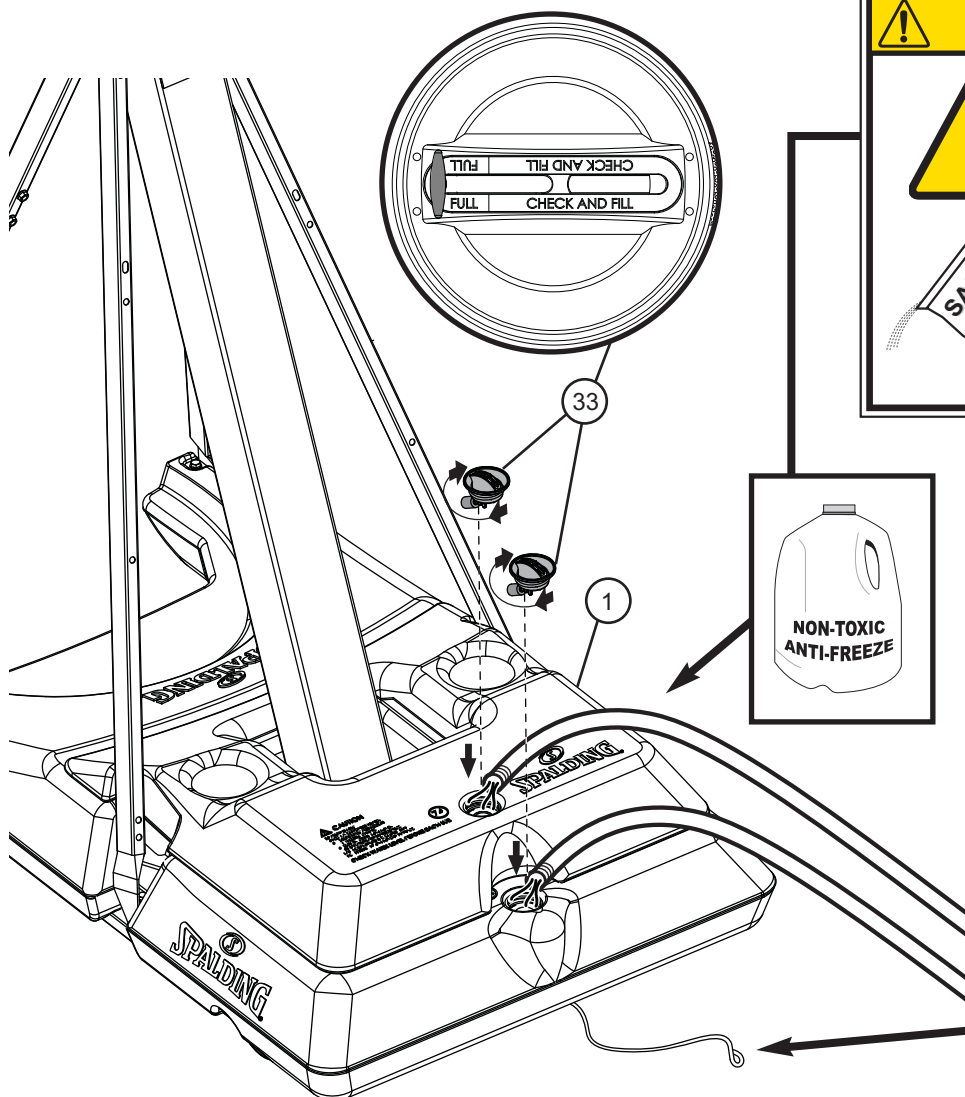

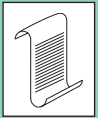
NOTE:
 <p>Make sure that the anchor rope is centered.</p>

SECTION E: ATTACH BOARD RIM

RIM ATTACHMENT HARDWARE CARD AND BAG

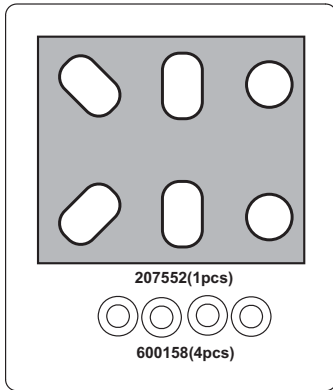

292901

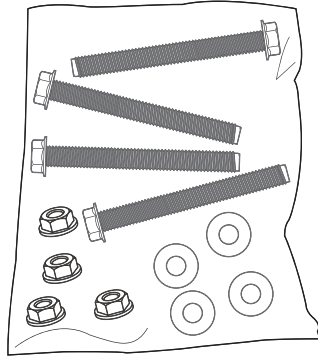

222700

TOOLS REQUIRED FOR THIS SECTION

(2) Wrenches

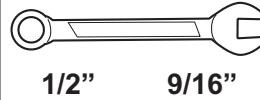

(2) Socket Wrenches and Sockets

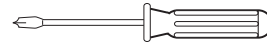
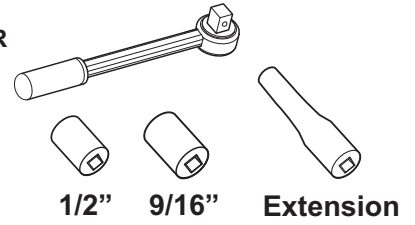

Phillips Screwdriver

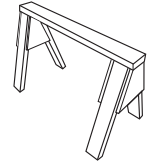

Sawhorse or Support Table

HARDWARE LIST AND IDENTIFIER

✓ Item Qty. Part No. Description

<input type="checkbox"/> 32	1		Board
<input type="checkbox"/> 40	1		Rim
<input type="checkbox"/> 41	1		Net
<input type="checkbox"/> R1	4	600158	Spacer, .87" O.D., 0.50 Long

✓ Item Qty. Part No. Description

<input type="checkbox"/> R2	1	207552	Foam, 1/16, 3x 4
<input type="checkbox"/> R3	4	201611	Bolt, Hex-Flange, 5/16-18 x 3" Long
<input type="checkbox"/> R4	4	203309	Washer, 3/8, 1: O.D.
<input type="checkbox"/> R5	4	203100	Nut, Hex-Flange, 5/16-18

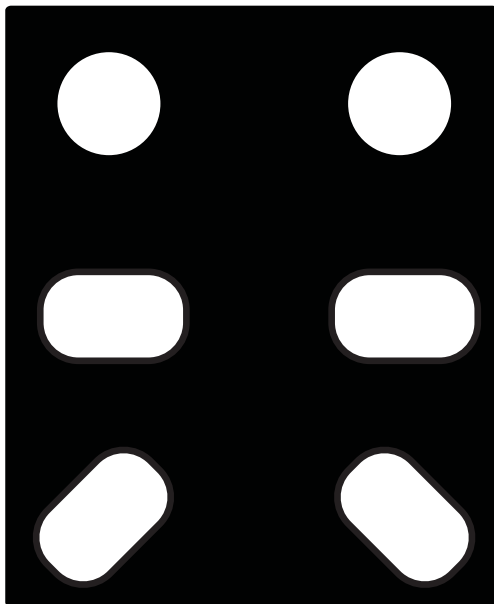

#R2 (1)



#R3 (4)

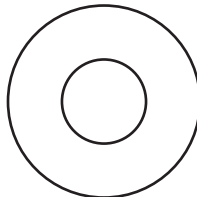

#R4 (4)

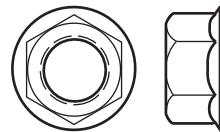

#R5 (4)



#R1 (4)

1. Remove screws that secure rim cover.

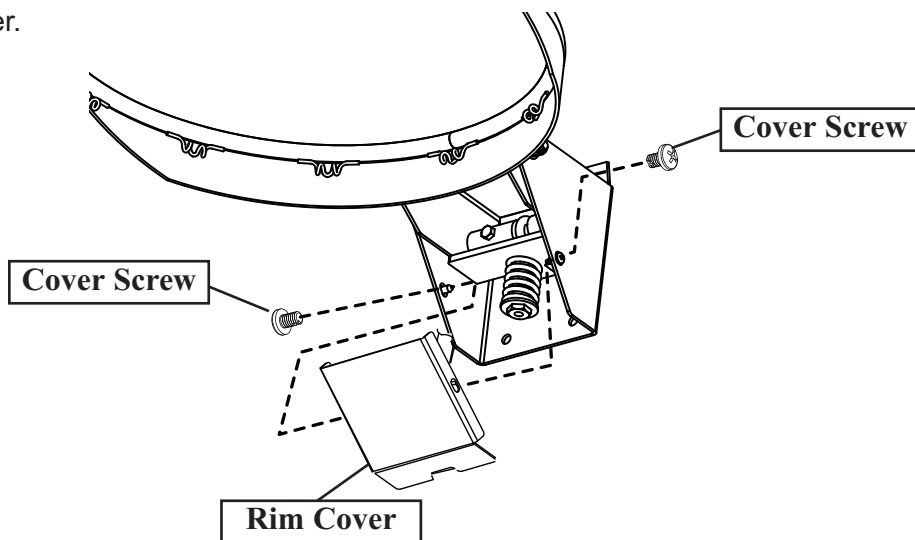

2. Adjust backboard to lowest setting and attach rim assembly (40) to board using bolts (R3), foam pad (R2), spacers (R1), washers (R4), and nuts (R5).

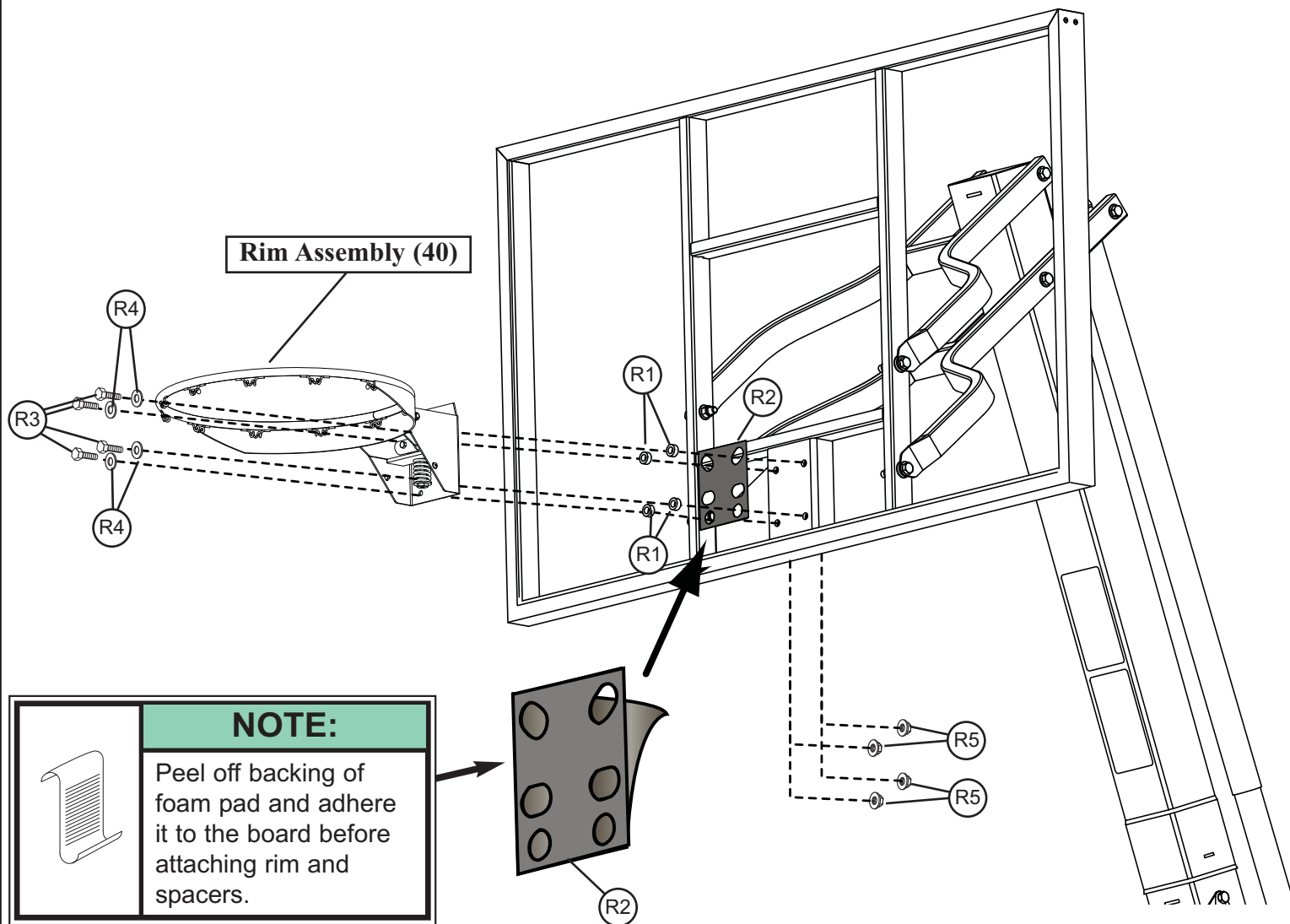

3.

Make adjustments as shown.

Tightening the nut, preloads the spring increases the rim's resistance to movement.

- The more the preload, the more force will be required to move the rim downward.

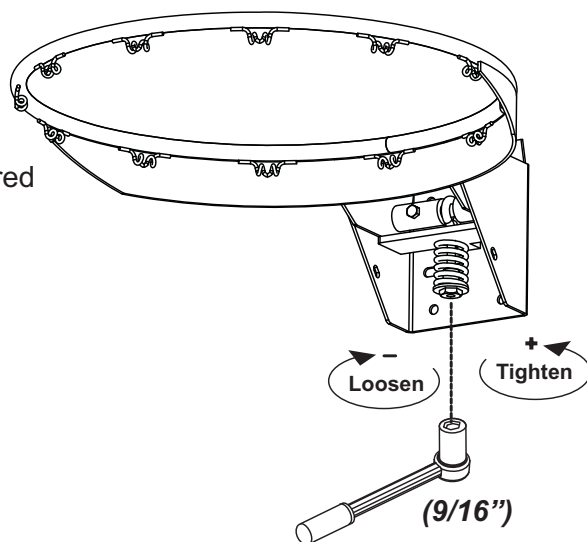

4.

Install cover plate on rim (40) using self tapping screws removed in step 1 of this section (note orientation of cover plate).

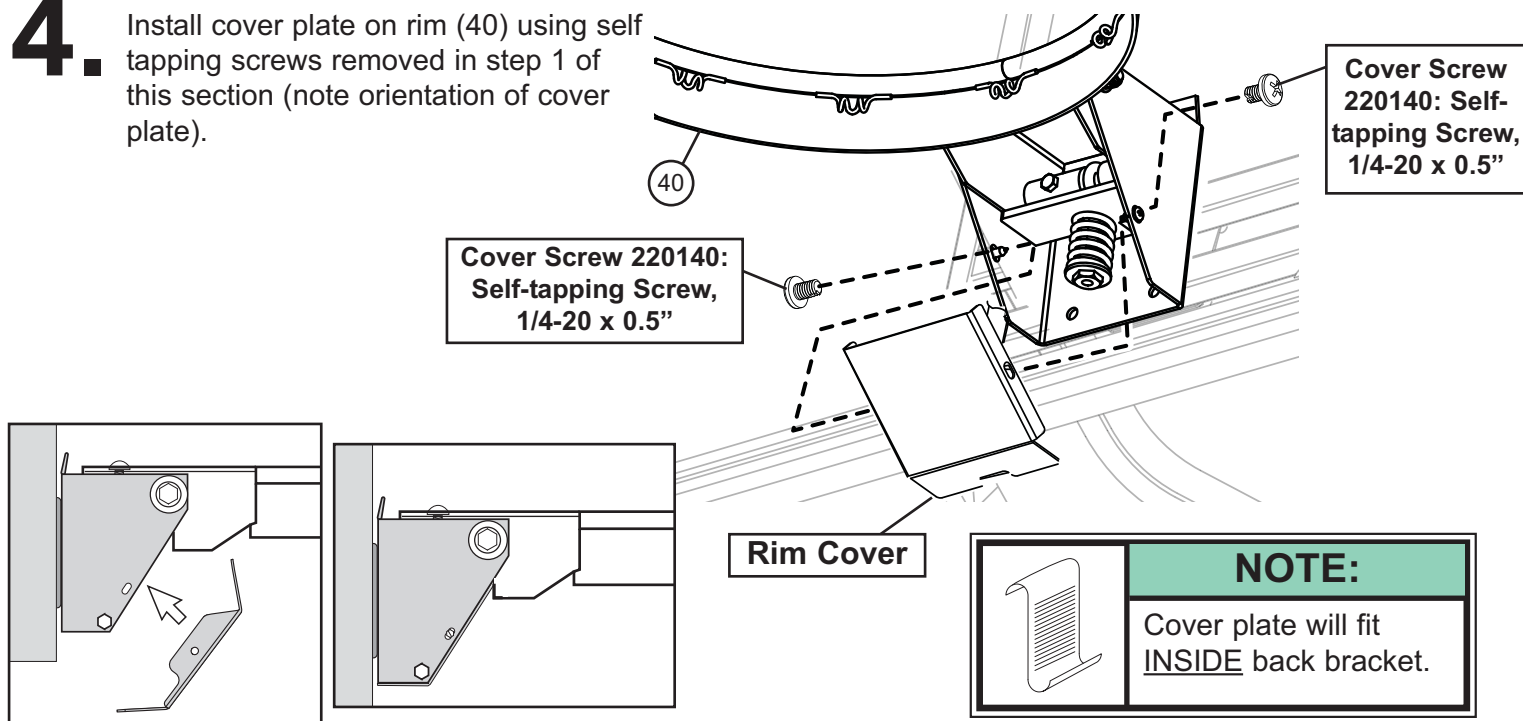

5.

Install net (41).

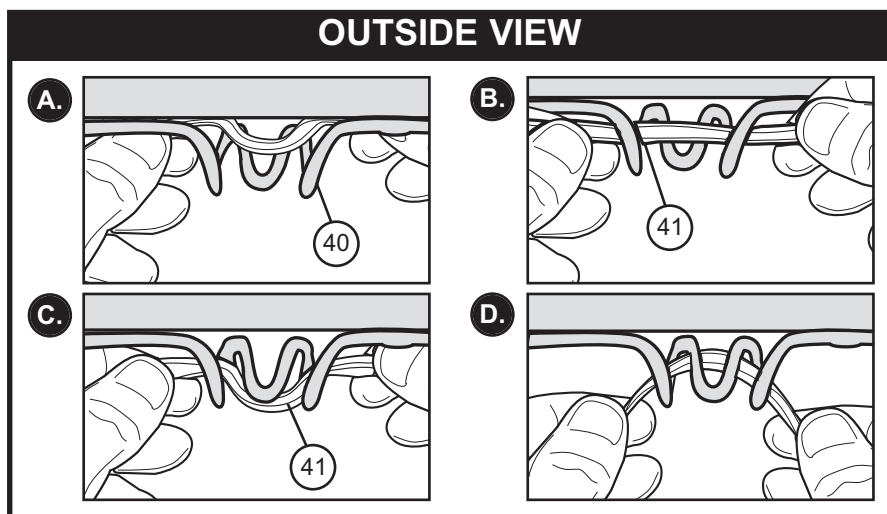

TOOLS REQUIRED FOR THIS SECTION

STADIUM AND BOARD PAD
HARDWARE CARD

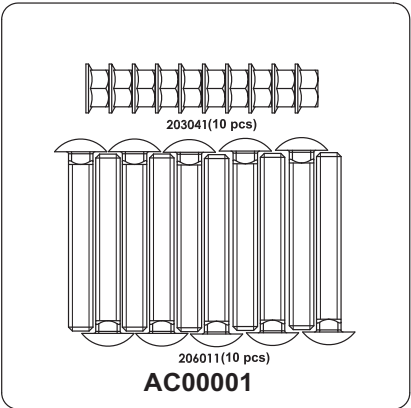

(2) Wrenches



9/16"

AND/OR

(2) Socket Wrenches and Sockets

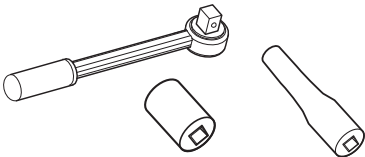

9/16"

Extension

HARDWARE LIST AND IDENTIFIER

<input checked="" type="checkbox"/> Item	Qty.	Part No.	Description	<input checked="" type="checkbox"/> Item	Qty.	Part No.	Description
<input type="checkbox"/> 50	1	600077	Stadium Pad, Bottom	<input type="checkbox"/> 53	1	574090	Label, Height Adjustment and Moving
<input type="checkbox"/> 51	1	600078	Stadium Pad, Top	<input type="checkbox"/> P1	10	206011	Bolt, Carriage, 3/8-16 x 2.75" Long
<input type="checkbox"/> 52	1	203124	Ground Stake	<input type="checkbox"/> P2	10	203041	Nut, Hex-Flange, 3/8-16

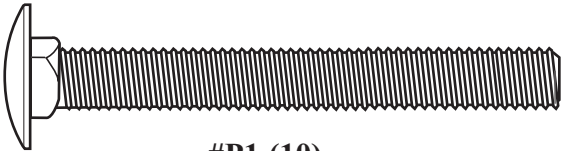

#P1 (10)

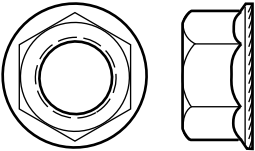

#P2 (10)

STADIUM PAD - INSTALLATION

1. Attach top stadium pad (51) with bolts (P1) and Nuts (P2).

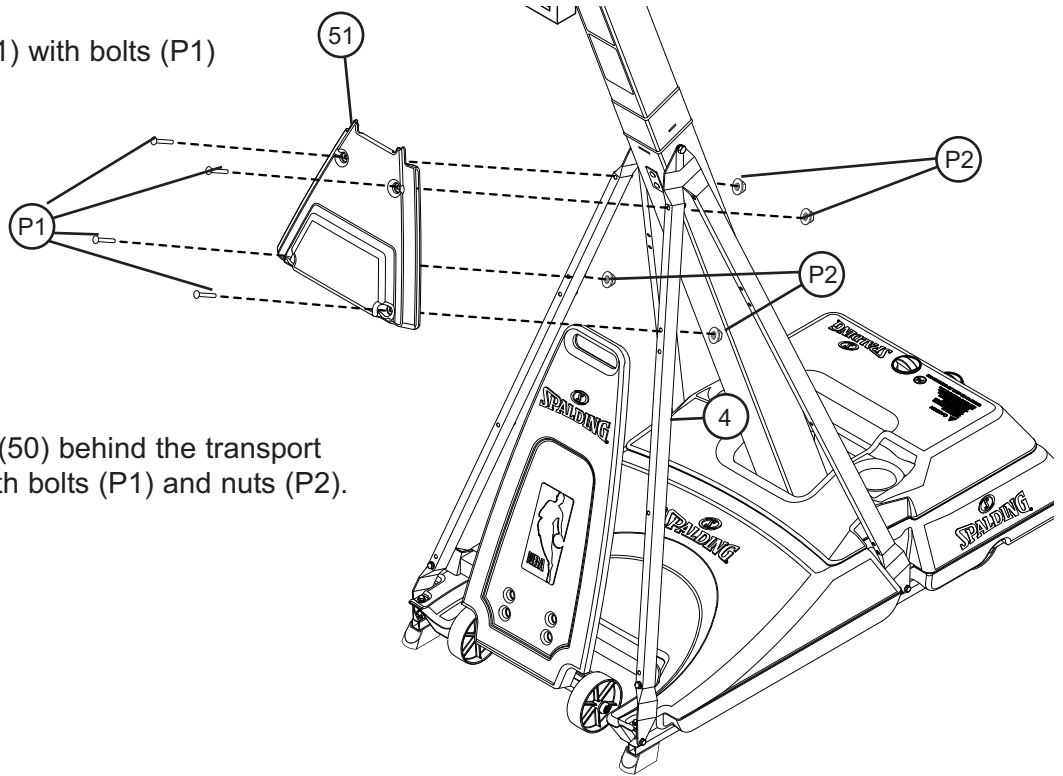

2. Slide bottom stadium pad (50) behind the transport handle (11) and secure with bolts (P1) and nuts (P2).

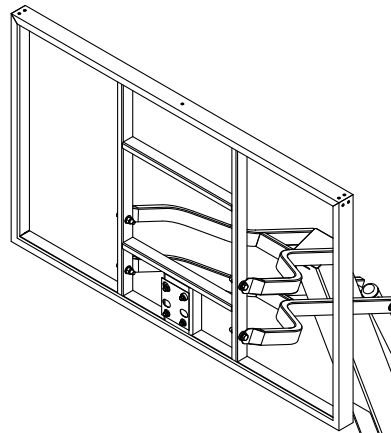
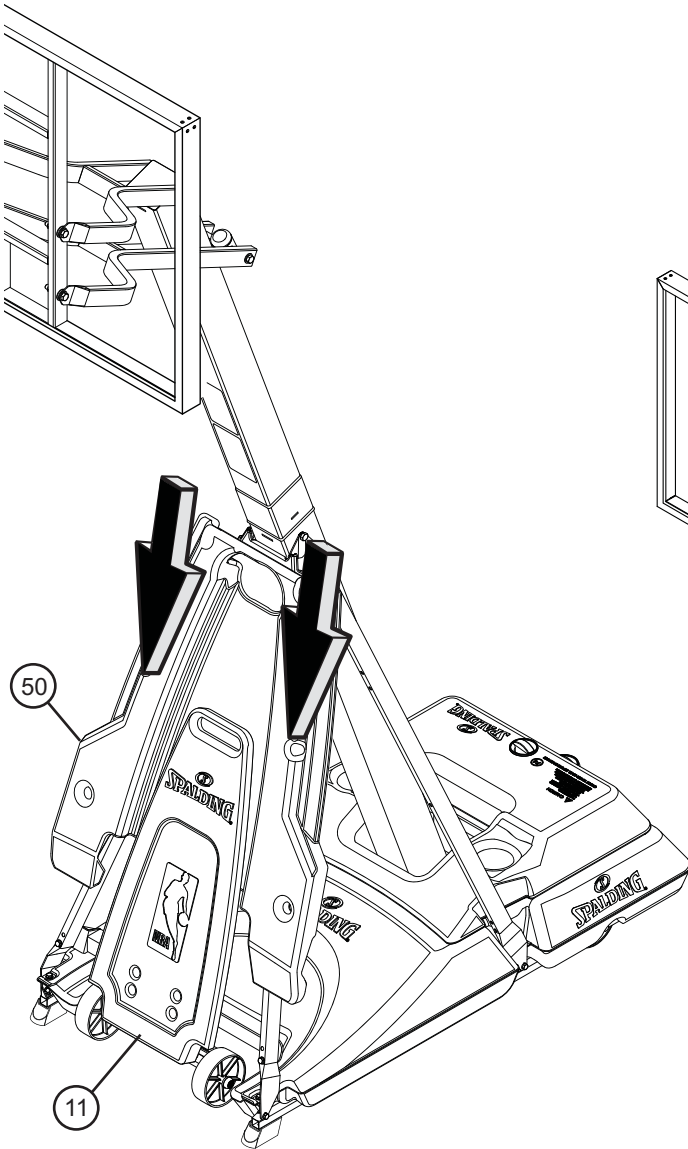

NOTE:

If necessary, slightly loosen bolts that secure front struts to pole and base frame (circled areas).

RE-TIGHTEN after stadium pads are attached.

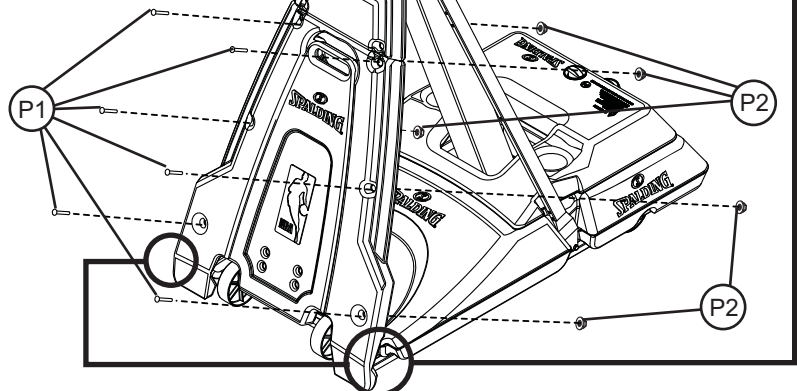

3.

Secure system by hooking loose end of rope onto ground stake (52).

Place stake so that when it is screwed into the ground the rope is taut.

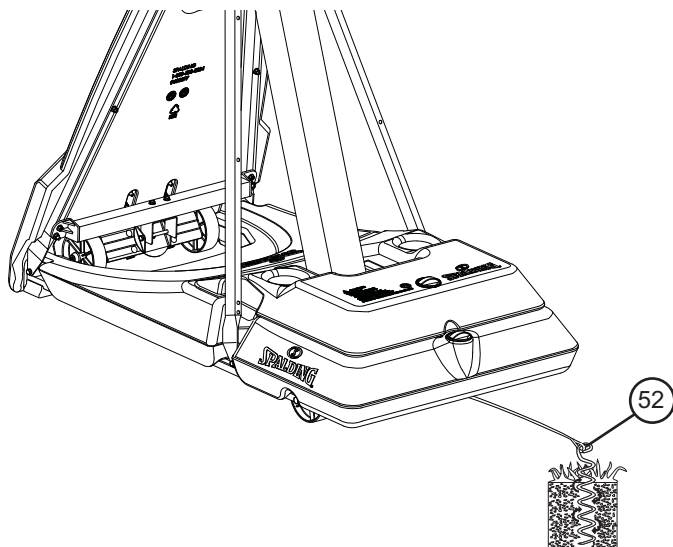

CAUTION!	
	<p>DO NOT OVER-CRANK HANDLE BEYOND THE MANUFACTURED HEIGHT-INDICATOR RANGE OF 7-1/2 - 10 FEET. DAMAGE MAY BE CAUSED TO THE SCREW JACK'S INTERNAL ADJUSTMENT MECHANISM IF ADJUSTED OVER 10 OR UNDER 7-1/2 FEET.</p>
	<p>HEIGHT AND MOVING LABEL MUST NOT OBSTRUCT FACTORY ATTACHED WARNING LABEL.</p>

4.

Apply Height Adjustment and Moving Label (53) to front of pole, where it is clearly visible.

NOTE:

If elevator is hard to adjust, slightly loosen bolts (circled areas).

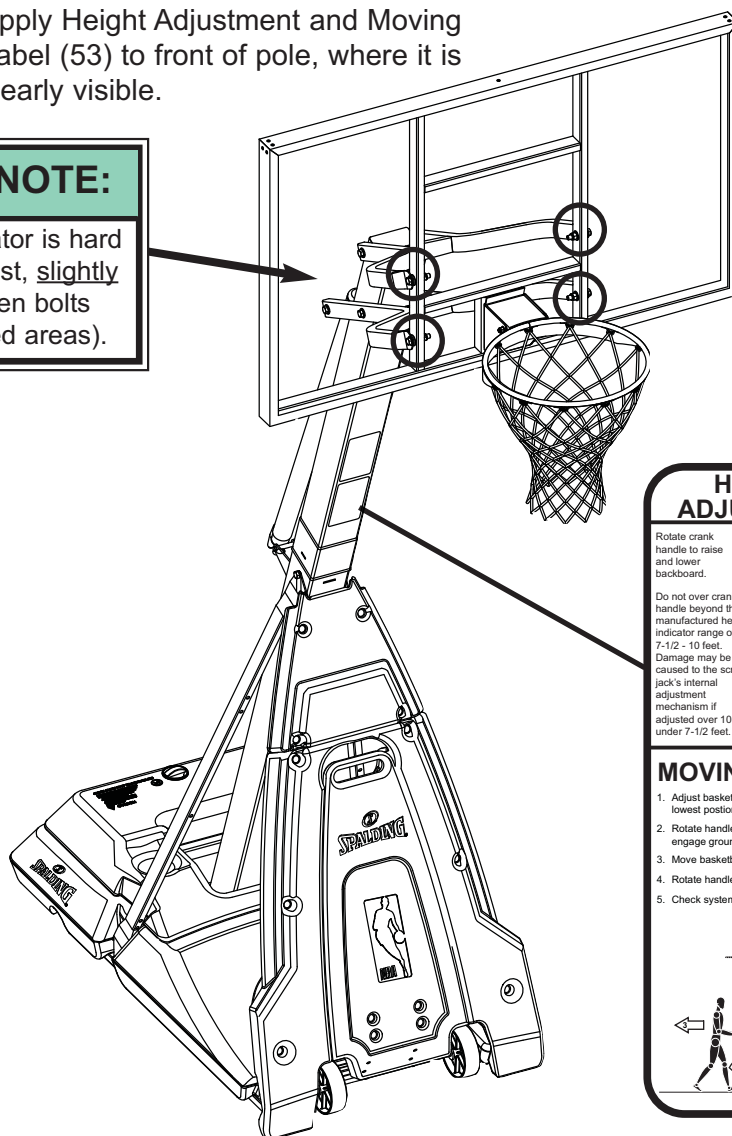

NOTE:

Handle (20) can be removed and stored by removing pin (24).

53

HEIGHT ADJUSTMENT

Rotate crank handle to raise and lower backboard.

Do not over crank handle beyond the manufactured height indicator range of 7-1/2 - 10 feet. Damage may be caused to the screw jack's internal adjustment mechanism if adjusted over 10 or under 7-1/2 feet.

MOVING SYSTEM

1. Adjust basketball backboard height to lowest position.
2. Rotate handle forward until wheels engage ground.
3. Move basketball system to desired location.
4. Rotate handle back to original position.
5. Check system for stability.

574090 12/06

NOTE:

Official rim height is 10-0' (3.05 m) from top of rim to playing surface.

**10 ft.
(3.05M)**